

COMEUP



- Limited Lifetime Warranty for Mechanical Components.
- Limited One (1) Year Warranty for Electrical Components.

AUTOMOTIVE WINCH

COMEUP winches are equipped with a heavy duty motor that delivers superior torque output and faster line speed for severe duty, self-recovery or utility duty Automotive applications. The Automotive winches come with U.S., Germany, U.K., France, etc patented automatic CBS (Cone Brake Structure) that completely holds in full load and is easily maintained. Explore and experience the quality of COMEUP Automotive winches that are the best solution for 4x4 Trucks and SUVs. They give you power whenever and wherever you need it!

▲ SELF-RECOVERY WINCH



▲ UTILITY DUTY WINCH



SELF-RECOVERY WINCH

COMEUP self-recovery winches provide the maximum line pull capacity from 6,000 to 18,000 lb respectively and all are equipped with the strongest power for safe effective winching, for working or playing in off-road environments. The 3-stage planetary gearbox delivers reliable and durable performance of the winch under the most rugged conditions. The U.S. Germany, U.K., France, etc patented automatic CBS (Cone Brake Structure) holds firmly in full load and provides easy maintenance. The greater the load on the wire rope, the greater amount of brake that is applied by the mechanism. Rotating ring gear clutch is a pull and turn design for rapid wire rope payout.

- All sealed high performance motor supplies superior torque output and faster line speed
- 3-stage planetary gearbox delivers the most reliable and durable performance of winch under the most rugged conditions.
- Heavy duty sealed contactor ensures sound waterproof protection
- An ergonomic T-handle positively engages the free spool clutch through multiple evenly spaced locking holes for rapid rope payout. The entire clutch can be rotated to reposition the "T" handle in multiple locations, to ease accessibility in various winch mounting positions.
- Protective thermal sensor LED
- Specific design of brake (CBS) outside the drum are ideally suited to heat-sensitive synthetic rope.
- Standard Compliance:
 - CE Machinery Directive 2006/42/EC
 - CE Electromagnetic Compatibility Directive 2004/108/EC

- Seal Series / 9,500 ~ 12,500 lb
- DV Series / 6,000 ~ 18,000 lb



COMEUP

SEAL SERIES WINCH



COMEUP new-generation Seal Series are 12,500 ~ 9,500 lb line -pulling capacities, high performance self-recovery winches that include nine models: Seal 12.5, Seal 12.5s, Seal 12.5rs, Seal 9.5, Seal 9.5s, Seal 9.5rs, Seal 9.5i, Seal 9.5si and Seal 9.5rsi. The "Seal" model designation represents its submersible capabilities. The "Seal" is at home underwater, in the mud, or on the driest land. Seal series winches come with a fully sealed transmission system with extreme-duty water resistance and Automatic full load Cone Brake Structure (CBS). The advantage of CBS - "Brake outside the drum" - allows rapid heat dispersion. It is ideally suited to

heat-sensitive synthetic ropes. Seal Series are uniquely design with a built-in waterproof receiver module in the wireless remote control that is certified by FCC & CE. A recovery damper and a pair of winching leather gloves come as added bonus.



Submersible Sealed Contactor

The brand new heavy-duty sealed contactor with silver-alloy contact pads, thick copper buss bars and submersible construction ensures weather resistance. It handles high amps and allows higher duty cycle. The industrial grade contactor is durable, reliable, and high performance.

Safety Warning Notice

The built-in waterproof receiver in the wireless remote control is equipped with a beeping buzzer and bright LED's to indicate motor overheating. (Only Seal 9.5rs / 12.5rs)

Aluminum Alloy Housings

Tough aluminum alloy die cast housings provide massive structural durability to withstand the strength of 2.0 x rated load of winch.

Hardened Steel 3-Stage Planetary Gear Train

Rugged and quiet planetary gears for maximum mechanical efficiency.

Rapid Rope Payout & Clutch Reposition

An ergonomic T-handle positively engages the free spool clutch through multiple evenly spaced locking holes. The entire clutch can be rotated to reposition the "T" handle in multiple locations, to ease accessibility in various winch mounting positions.

Automatic, Full Load Cone Brake Structure (CBS)

The U.S. Germany, U.K. France, etc patented brake system automatically endures full load without slipping. With CBS, the greater the load on the rope, the greater amount of braking is generated by the mechanism. Furthermore, the braking mechanism mounted outside the drum rather than inside the drum expedites heat dispersion and also makes this winch ideal for use with synthetic rope.

Extreme-duty Sealed

Extreme-duty water resistance on the motor and gearbox housing joints.

All Sealed High Performance Motor

Heavy duty series wound motor delivers superior torque output and faster line speed. A built-in thermal detector automatically sends a warning signal to the "Remote Control" when motor is over-heated.



The industrial grade waterproof remote control comes with a thermometric LED indicator on the hand-held switch that automatically alerts when the motor is over-heated.

Wiring harness with built-in antenna designed for quick installation and easy wireless operation

IP66 waterproof transmitter and receiver ensure all weather protection



2.4 GHz high frequency device features never in-band interference within 27m (90') radius



Colour LED indicates different winching conditions



Seal 12.5 Self-Recovery Winch

- Rated Line Pull : **5,670 kg / 12,500 lb**
- Part Number : **PN 291250** 12V DC motor
- Comes with wire rope and roller fairlead

**Seal 12.5s Self-Recovery Winch**

- Rated Line Pull : **5,670 kg / 12,500 lb**
- Part Number : **PN 291260** 12V DC motor
- Comes with synthetic rope and hawse fairlead

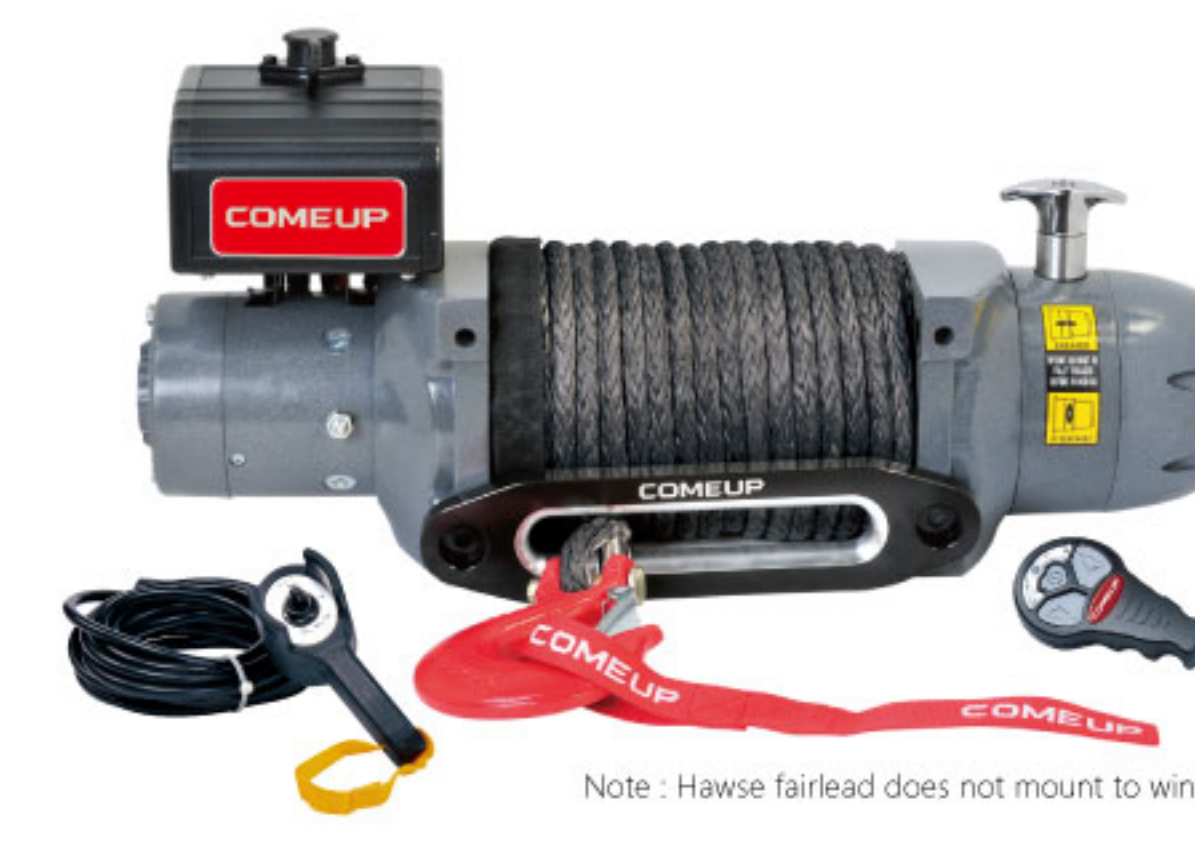
**Seal 12.5rs Self-Recovery Winch**

- Rated Line Pull : **5,670 kg / 12,500 lb**
- Part Number : **PN 291270** 12V DC motor
- Comes with wireless receiver built-in control pack, synthetic rope and hawse fairlead

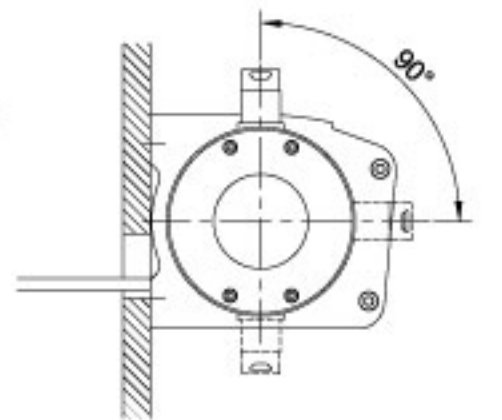
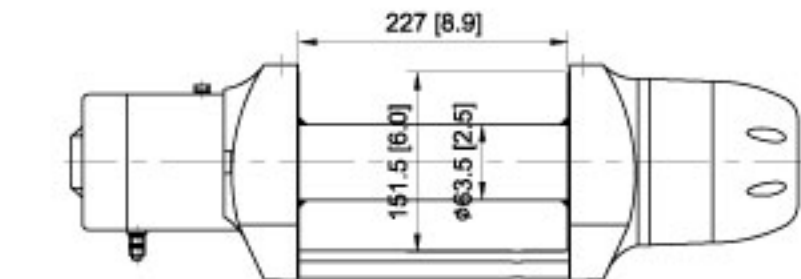
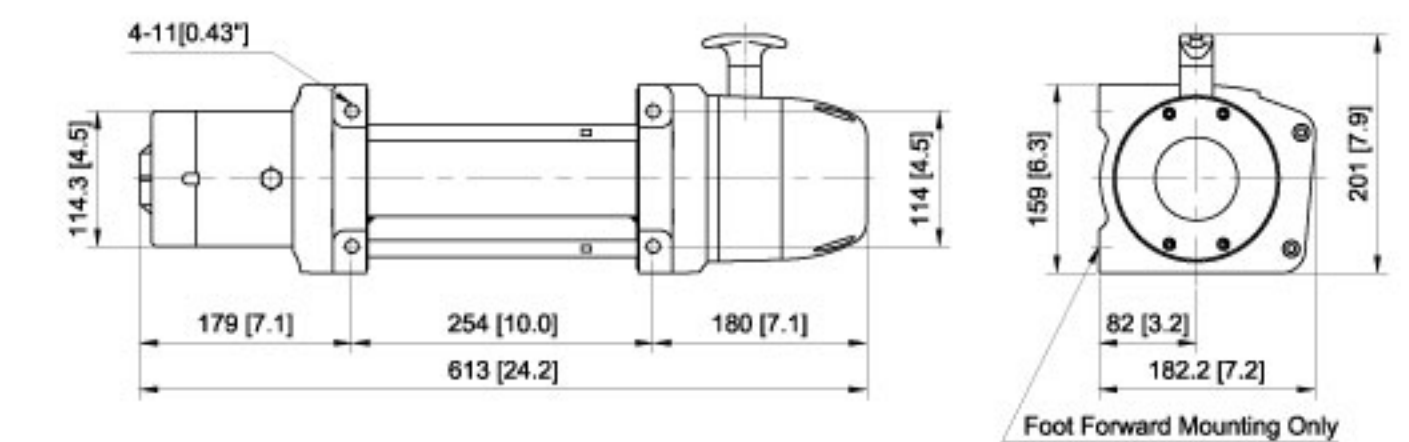
**DIMENSION mm/in (Seal 12.5/12.5s/12.5rs)**

- 4 equally positioned pin holes ensure seamless clutch transmission and make it easily rotate by 90° increments. (Seal 12.5/12.5s/12.5rs)

SPECIFICATIONS : (Seal 12.5/12.5s/12.5rs)

- **Rated line pull** : 5,670 kg (12,500 lb) single line
- **Motor** : 3,730 w / 5.0 hp 12V series wound
- **Gear ratio** : 3-stage planetary 225:1
- **Clutch (freespooling)** : Rotating ring gear
- **Brake (outside the drum)** : Automatic, full load CBS (Cone Brake Structure)
- **Winch construction** : Aluminum die cast housings with steel drum
- **Drum size** : 63.5 x 227 mm (2.5" x 8.9")
- **Control** :
 - Seal 12.5/12.5s** : Waterproof remote with thermometric indicator LED w/5 m (17') cord
 - Seal 12.5rs** : Both built-in digital signal two ways wireless remote control and waterproof remote with thermometric indicator LED w/5 m (17') cord
- **Rope type** :
 - Seal 12.5** : Galvanized aircraft A7 x 19 wire rope
 - Seal 12.5s/12.5rs** : Synthetic rope SK-75
- **Rope size** :
 - Seal 12.5** : 9.5 mm x 25 m (3/8" x 82')
 - Seal 12.5s/12.5rs** : 11 mm x 25 m (7/16" x 82')
- **Mounting bolts pattern** : 254 x 114 mm (10" x 4.5")
- **Mounting** : Foot forward mounting only
- **Winch weight (including rope)** :
 - Seal 12.5** : 34.5 kg / 76 lb
 - Seal 12.5s/12.5rs** : 28 kg / 61.7 lb
- **Gross weight** :
 - Seal 12.5** : 48.5 kg / 107 lb
 - Seal 12.5s/12.5rs** : 40.5 kg / 89.1 lb
- **Box dimension** : 682 x 209 x 453 mm (26.8" x 8.2" x 17.8")

PERFORMANCE DATA (Seal 12.5/12.5s/12.5rs)**Line Pull and Rope Capacity**

Layer of Rope	Pull by Layer, kg / lb	Total Rope on the Drum, m / ft
1 st	5,670 / 12,500	5.4 / 17.7
2 nd	4,499 / 9,919	12.1 / 39.7
3 rd	3,729 / 8,221	20.3 / 66.6
4 th	3,184 / 7,020	25 / 82

Line Speed and Amp. Draw (1st layer of rope on the drum)

Line Pull kg / lb	Line Speed mpm / fpm	Amp. Draw 12V
No Load	7.5 / 24.6	45
907 / 2,000	3.4 / 11.2	75
1,814 / 4,000	2.5 / 8.2	160
2,722 / 6,000	2 / 6.6	230
3,629 / 8,000	1.6 / 5.2	300
4,535 / 10,000	1.2 / 3.9	375
5,670 / 12,500	0.9 / 3	470

- ▲ New Design Color Box for Seal 12.5/12.5s/12.5rs, Seal 9.5/9.5s/9.5rs



Seal 9.5 Self-Recovery Winch

- Rated Line Pull : **4,309 kg / 9,500 lb**
- Part Number : **PN 294666** 12V DC motor
- Comes with wire rope and roller fairlead

**Seal 9.5s Self-Recovery Winch**

- Rated Line Pull : **4,309 kg / 9,500 lb**
- Part Number : **PN 293010** 12V DC motor
- Comes with synthetic rope and hawse fairlead

**Seal 9.5rs Self-Recovery Winch**

- Rated Line Pull : **4,309 kg / 9,500 lb**
- Part Number : **PN 293655** 12V DC motor
- Comes with wireless receiver built-in control pack, synthetic rope and hawse fairlead

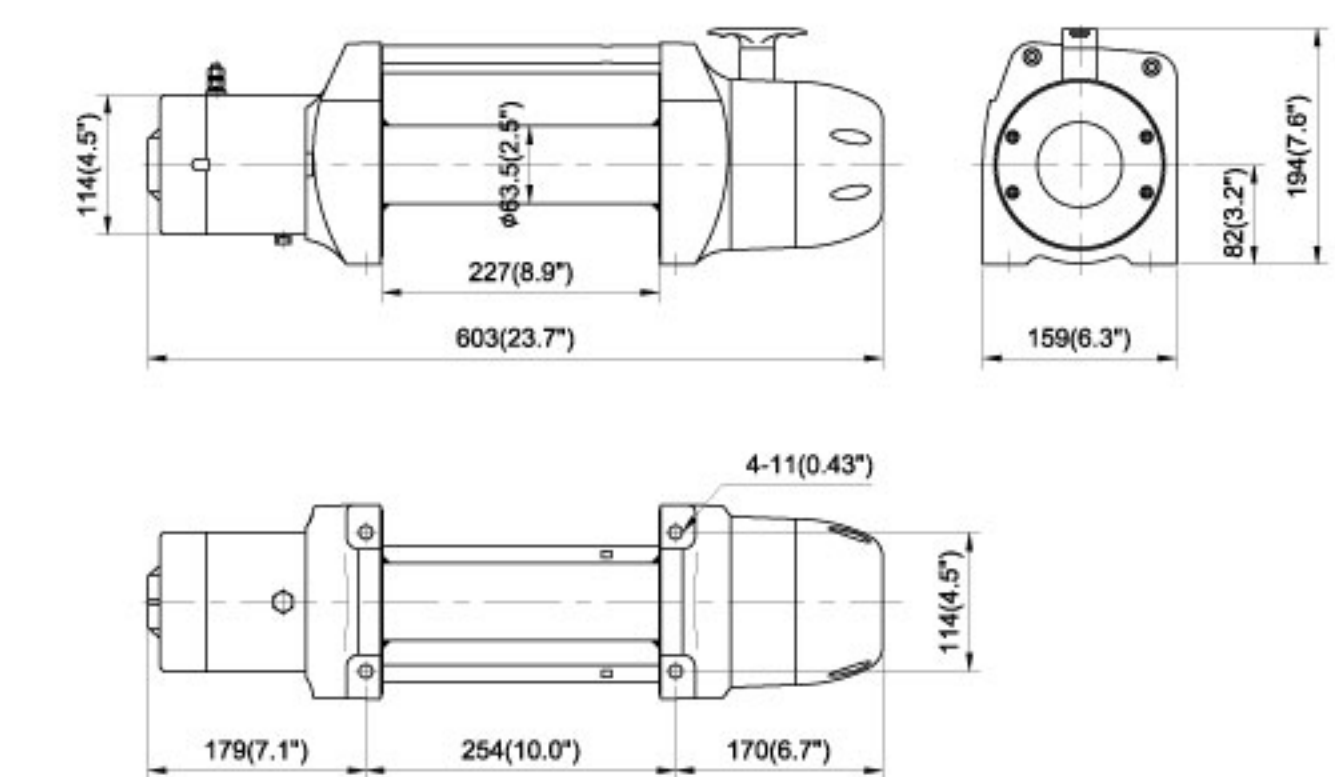
**DIMENSION mm/in (Seal 9.5/9.5s/9.5rs)**

- ▶ 4 equally positioned pin holes ensure seamless clutch transmission and make it easily rotate by 90° Increments. (Seal 9.5/9.5s/9.5rs)

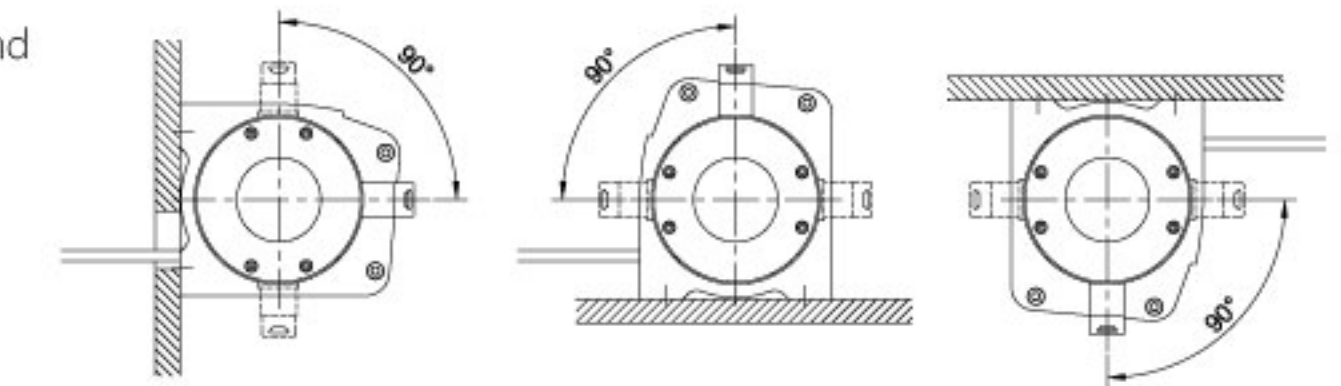
**SPECIFICATIONS : (Seal 9.5/9.5s/9.5rs)**

- **Rated line pull** : 4,309 kg (9,500 lb) single line
- **Motor** : 3,730 w / 5.0 hp 12V series wound
- **Gear ratio** : 3-stage planetary 159:1
- **Clutch (freespooling)** : Rotating ring gear
- **Brake (outside the drum)** : Automatic, full load CBS (Cone Brake Structure)
- **Winch construction** : Aluminum die cast housings with steel drum
- **Drum size** : 63.5 x 227 mm (2.5" x 8.9")
- **Control** :
 - Seal 9.5 / 9.5s** : Waterproof remote with thermometric indicator LED w/5 m (17') cord
 - Seal 9.5rs** : Both built-in digital signal two ways wireless remote control and waterproof remote with thermometric indicator LED w/5 m (17') cord
- **Rope type** :
 - Seal 9.5** : Galvanized aircraft A7 x 19 wire rope
 - Seal 9.5s / 9.5rs** : Synthetic rope SK-75
- **Rope size** :
 - Seal 9.5** : 8.7 mm x 30.5 m (11/32" x 100')
 - Seal 9.5s / 9.5rs** : 10 mm x 30.5 m (3/8" x 100')
- **Mounting bolts pattern** : 254 x 114 mm (10" x 4.5")
- **Winch weight (including rope)** :
 - Seal 9.5** : 34.5 kg / 76 lb
 - Seal 9.5s / 9.5rs** : 28 kg / 61.7 lb
- **Gross weight** :
 - Seal 9.5** : 48.5 kg / 107 lb
 - Seal 9.5s / 9.5rs** : 40.5 kg / 89.1 lb
- **Box dimension** : 682 x 209 x 453 mm (26.8" x 8.2" x 17.8")

PERFORMANCE DATA (Seal 9.5/9.5s/9.5rs)**Line Pull and Rope Capacity**

Layer of Rope	Pull by Layer, kg / lb	Total Rope on the Drum, m / ft
1 st	4,309 / 9,500	5.8 / 19.1
2 nd	3,472 / 7,655	13.1 / 42.9
3 rd	2,908 / 6,410	21.7 / 71.2
4 th	2,501 / 5,514	30.5 / 100

Line Speed and Amp. Draw (1st layer of rope on the drum)

Line Pull kg / lb	Line Speed mpm / fpm	Amp. Draw 12V
No Load	19 / 62	60
907 / 2,000	4.7 / 15.2	115
1,814 / 4,000	3.5 / 11.5	210
2,722 / 6,000	2.8 / 9.2	245
3,629 / 8,000	2.3 / 7.6	280
4,309 / 9,500	2.1 / 6.8	380



Seal 9.5i Self-Recovery Winch

- Rated Line Pull : **4,309 kg / 9,500 lb**
- Part Number : **PN 299368** 12V DC motor
- Comes with wire rope and roller fairlead

**Seal 9.5si Self-Recovery Winch**

- Rated Line Pull : **4,309 kg / 9,500 lb**
- Part Number : **PN 293220** 12V DC motor
- Comes with synthetic rope and hawse fairlead

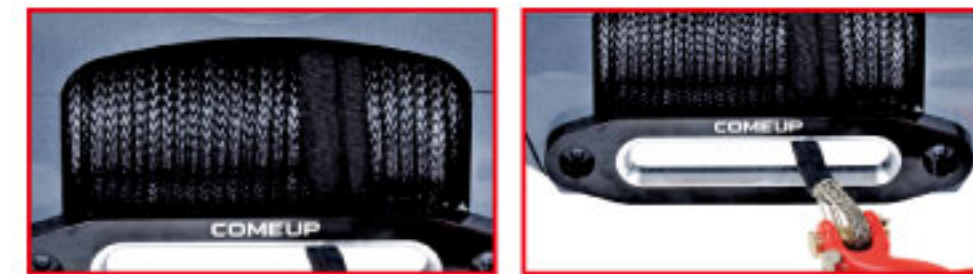
**Seal 9.5rsi Self-Recovery Winch**

- Rated Line Pull : **4,309 kg / 9,500 lb**
- Part Number : **PN 293244** 12V DC motor
- Comes with wireless receiver built-in control pack, synthetic rope and hawse fairlead

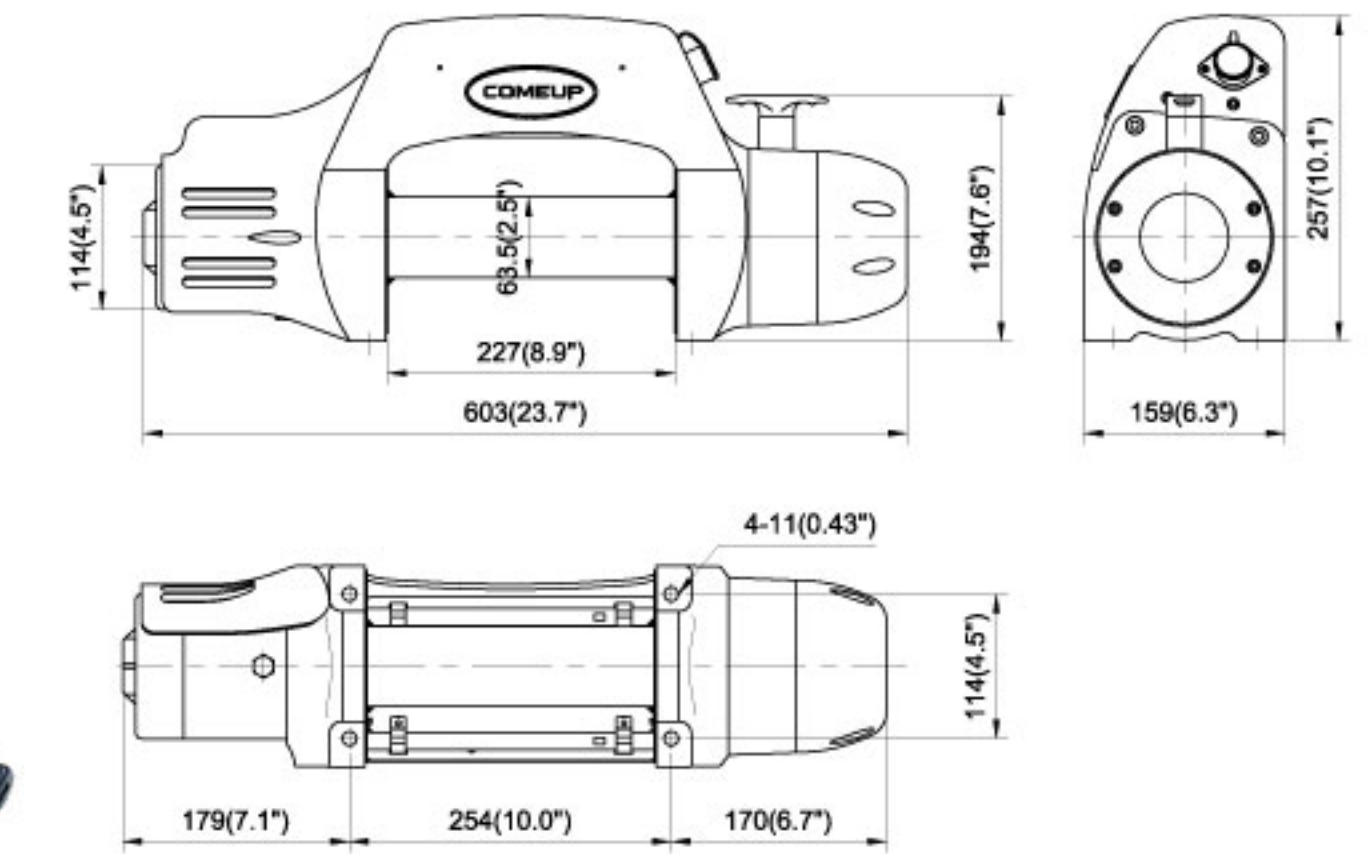
**DIMENSION mm/in (Seal 9.5i/9.5si/9.5rsi)**

- ▶ 4 equally positioned pin holes ensure seamless clutch transmission and make it easily rotate by 90° Increments. (Seal 9.5i/9.5si/9.5rsi)

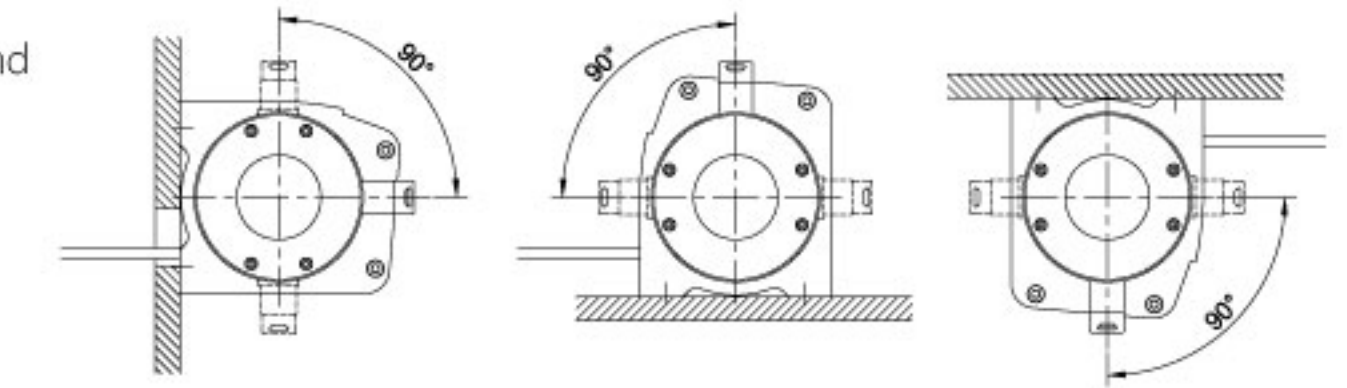
**SPECIFICATIONS : (Seal 9.5i/9.5si/9.5rsi)**

- **Rated line pull** : 4,309 kg (9,500 lb) single line
- **Motor** : 3,730 w / 5.0 hp 12V series wound
- **Gear ratio** : 3-stage planetary 159:1
- **Clutch (freespooling)** : Rotating ring gear
- **Brake (outside the drum)** : Automatic, full load CBS (Cone Brake Structure)
- **Winch construction** : Aluminum die cast housings with steel drum
- **Drum size** : 63.5 x 227 mm (2.5" x 8.9")
- **Control** :
 - Seal 9.5i / 9.5si** : Waterproof remote with thermometric indicator LED w/5 m (17') cord
 - Seal 9.5rsi** : Both built-in digital signal two ways wireless remote control and waterproof remote with thermometric indicator LED w/5 m (17') cord
- **Rope type** :
 - Seal 9.5i** : Galvanized aircraft A7 x 19 wire rope
 - Seal 9.5si / 9.5rsi** : Synthetic rope SK-75
- **Rope size** :
 - Seal 9.5i** : 8.7 mm x 30.5 m (11/32" x 100')
 - Seal 9.5si / 9.5rsi** : 10 mm x 30.5 m (3/8" x 100')
- **Mounting bolts pattern** : 254 x 114 mm (10" x 4.5")
- **Winch weight (including rope)** :
 - Seal 9.5i** : 38.5 kg / 85 lb
 - Seal 9.5si / 9.5rsi** : 32 kg / 70.5 lb
- **Gross weight** :
 - Seal 9.5i** : 52.5 kg / 116 lb
 - Seal 9.5si / 9.5rsi** : 44.5 kg / 97.9 lb
- **Box dimension** : 682 x 209 x 453 mm (26.8" x 8.2" x 17.8")

PERFORMANCE DATA (Seal 9.5i/9.5si/9.5rsi)**Line Pull and Rope Capacity**

Layer of Rope	Pull by Layer, kg / lb	Total Rope on the Drum, m / ft
1 st	4,309 / 9,500	5.8 / 19.1
2 nd	3,472 / 7,655	13.1 / 42.9
3 rd	2,908 / 6,410	21.7 / 71.2
4 th	2,501 / 5,514	30.5 / 100

Line Speed and Amp. Draw (1st of wire rope on the drum)

Line Pull kg / lb	Line Speed mpm / fpm	Amp. Draw 12V
No Load	19 / 62	60
907 / 2,000	4.7 / 15.2	115
1,814 / 4,000	3.5 / 11.5	210
2,722 / 6,000	2.8 / 9.2	245
3,629 / 8,000	2.3 / 7.6	280
4,309 / 9,500	2.1 / 6.8	380

- ▶ New Design Color Box for Seal 9.5i/9.5si/9.5rsi

**Protective Thermal Sensor LED**

The industrial grade waterproof remote control comes with a thermometric LED indicator on the hand-held switch that automatically alerts when the motor is over-heated.

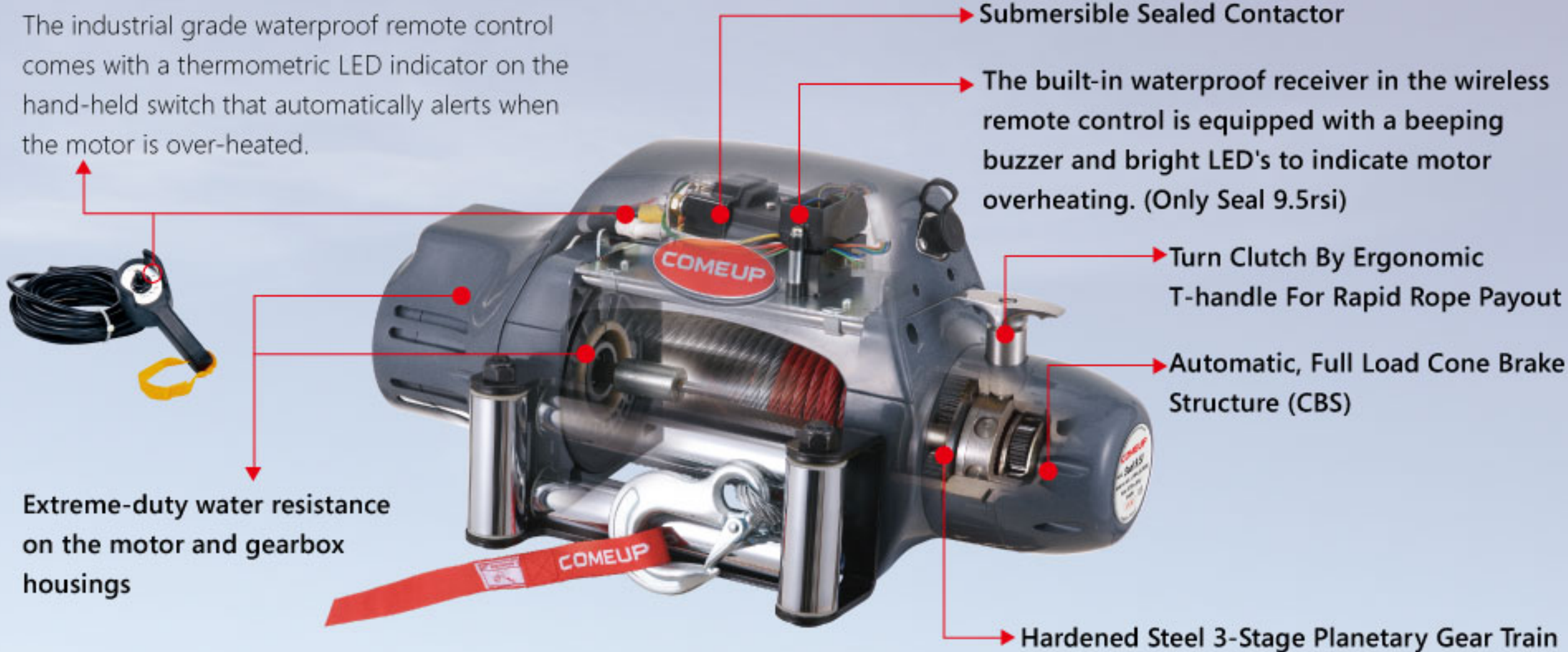

DV SERIES WINCH

Magnetic North Pole Exploration

Background....

In December 2007 Arctic Trucks modified two Toyota Hilux (Tacoma) vehicles for an expedition with BBC Television's Top Gear show, Toyota GB and Polar Challenge to the Magnetic North Pole. Three of Arctic Trucks (COMEUP Distributor in ICE- LAND) employees joined this expedition as drivers and mechanics.

This was a challenging trip, for one thing the ice north of Helena Island was unusually bad with very large bolder fields that were hostile to anything moving. The second challenge was to carry a film crew, all their equipment and taking valuable time and energy for filming.

Map of Magnetic North Pole Exploration

The drive was close to 700 km, see picture, and took close to 7 days mostly on sea ice.

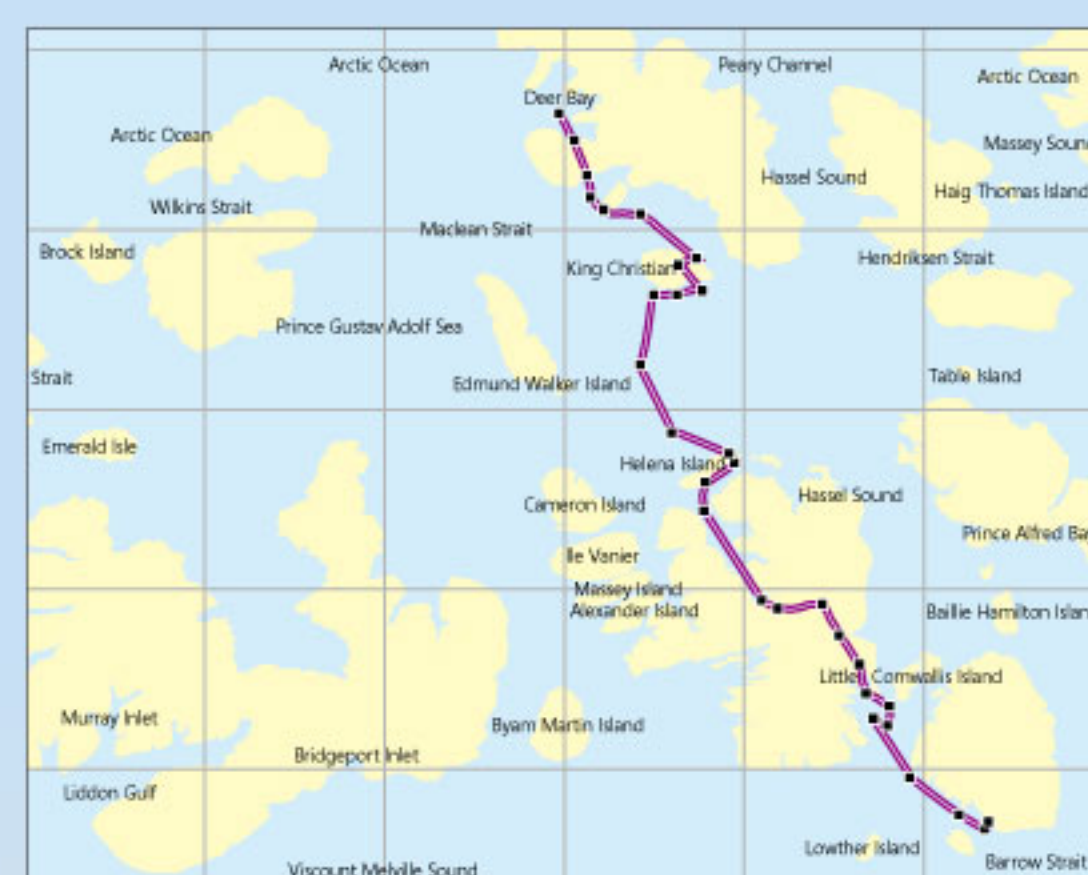

DV-18 Self-Recovery Winch



- Rated Line Pull : **8,181 kg / 18,000 lb**
- Part Number : **PN 851824** 24V DC motor

SPECIFICATIONS :

- **Rated line pull** : 8,181 kg (18,000 lb) single line
- **Motor** : 4,474 w / 6.0 hp 24V series wound
- **Gear ratio** : 3-stage planetary 315:1
- **Clutch (freespooling)** : Rotating ring gear
- **Brake (outside the drum)** : Automatic, full load CBS (Cone Brake Structure)
- **Winch construction** : Aluminum die cast housings with steel drum
- **Drum size** : 89 x 192 mm (3.5" x 7.6")
- **Control** : Waterproof remote with thermometric indicator LED w/ 5 m (17') cord
- **Rope type** : 6x29- IWRC
- **Rope size** : 12.7 mm x 25 m (1/2" x 82')
- **Mounting bolts pattern** :
254 x 114 mm (10" x 4.5")
254 x 165 mm (10" x 6.5")
- **Mounting** : Foot forward mounting only
- **Winch weight (including rope)** : 59 kg / 130 lb
- **Gross weight** : 71 kg / 156.5 lb
- **Box dimension** : 695 x 265 x 420 mm (27.3" x 10.4" x 16.5")

DIMENSION mm/in

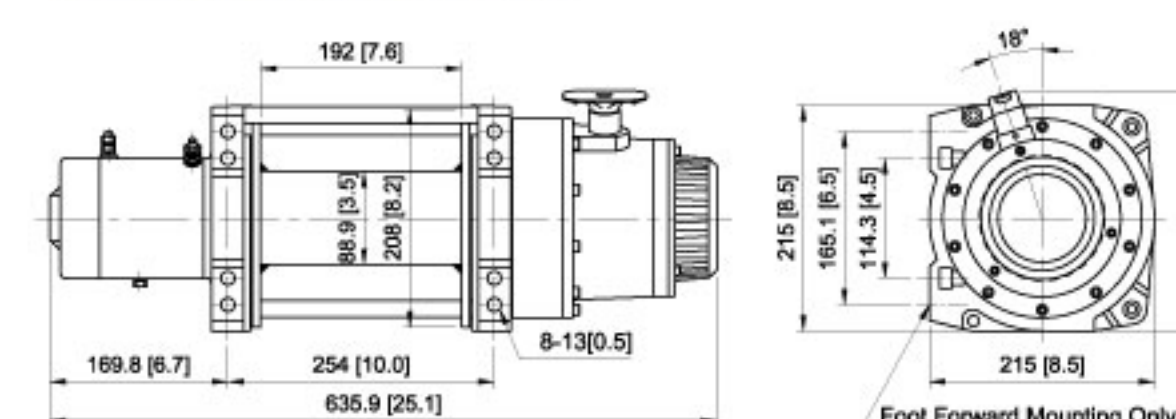

- 10 equally positioned pin holes ensure seamless clutch transmission and make it easily rotate by 36° increments

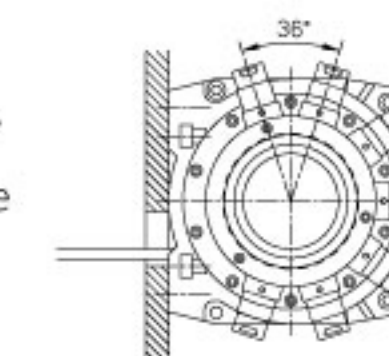

Most Powerful and Efficient

- Features of compact size, light-weight, extreme low profile and spec. leading 18,000 lb pulling make it the optimal winch to fit in the limited space on most of the current vehicles.
- 10 equally positioned pin holes with a stainless steel ergonomic T-handle make it possible to reposition in 36 degree Increments.
- Hardened steel, 3-stage planetary gear train for efficient and reliable operation.
- Waterproof remote control with thermometric LED indicator alerts when the motor is over-heated.
- U.S. Germany, U.K. France, etc patented mechanical cone brake holds the full load without slipping.
- Meet international standards such as SAE J706, CE Machinery Directive 2006/42/EC and CE EMC Directive 2004/108/EC.

PERFORMANCE DATA

Line Pull and Rope Capacity

Layer of Wire Rope	Pull by Layer, kg / lb	Total Rope on the Drum, m / ft
1 st	8,181 / 18,000	4.7 / 15.4
2 nd	6,546 / 14,431	10.5 / 34.4
3 rd	5,456 / 12,028	17.5 / 57.4
4 th	4,677 / 10,311	25 / 82

Line Speed and Amp. Draw (1st layer of wire rope on the drum)

Line Pull kg / lb	Line Speed mpm / fpm	Amp. Draw 24V
No Load	8.6 / 28.2	40
1,814 / 4,000	7.3 / 24	70
3,630 / 8,000	6.1 / 20	140
4,535 / 10,000	4.8 / 15.7	180
5,443 / 12,000	3.5 / 11.5	210
6,804 / 15,000	2.3 / 7.5	260
8,181 / 18,000	1 / 3.3	320

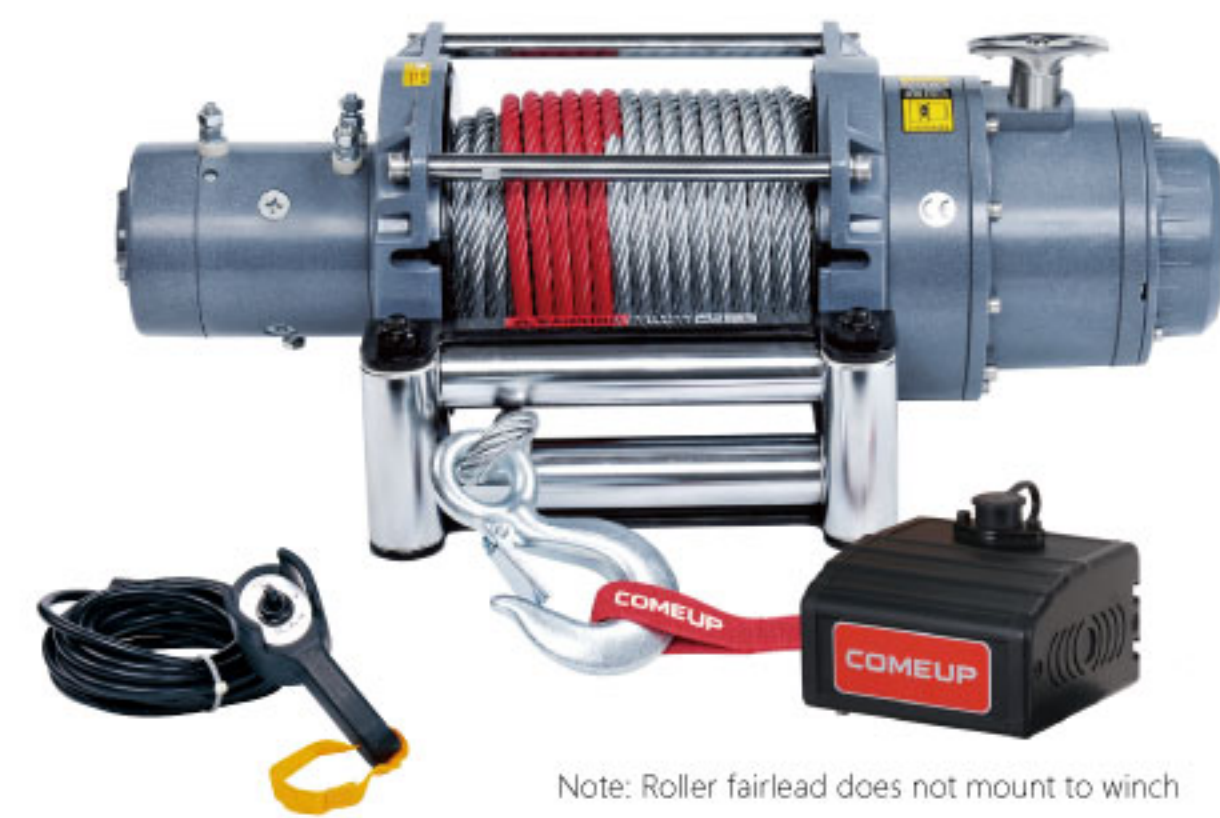

DV-15 Self-Recovery Winch

Note: Roller fairlead does not mount to winch

- Rated Line Pull : **6,804 kg / 15,000 lb**
- Part Number : **PN 857326** 12V DC motor
PN 857433 24V DC motor

SPECIFICATIONS :

- **Rated line pull** : 6,804 kg (15,000 lb) single line
- **Motor** :
4,180 w / 5.6 hp 12V series wound
2,690 w / 3.6hp 24V series wound
- **Gear ratio** : 3-stage planetary 315:1
- **Clutch (freespooling)** : Rotating ring gear
- **Brake (outside the drum)** : Automatic, full load CBS (Cone Brake Structure)
- **Winch construction** : Aluminum die cast housings with steel drum
- **Drum size** : 89 x 206 mm (3.5" x 8.1")
- **Control** : Waterproof remote with thermometric indicator LED w/ 5 m (17') cord
- **Rope type** : 6 x 29 - IWRC
- **Rope size** : 11.1 mm x 27 m (7/16" x 89')
- **Mounting bolts pattern** :
254 x 114 mm (10" x 4.5")
254 x 165 mm (10" x 6.5")
- **Winch weight (including rope)** : 57 kg / 125.4 lb
- **Gross weight** : 69 kg / 152 lb
- **Box dimension** : 695 x 265 x 420 mm (27.3" x 10.4" x 16.5")

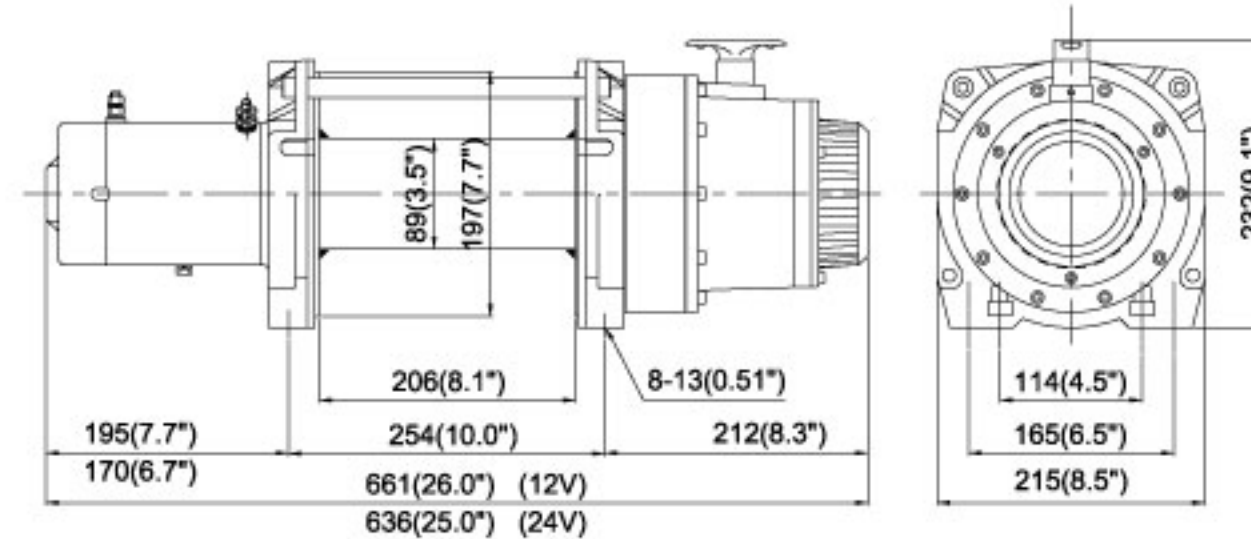
DIMENSION mm/in

- ▶ 10 equally positioned pin holes ensure seamless clutch transmission and make it easily rotate by 36° Increments.

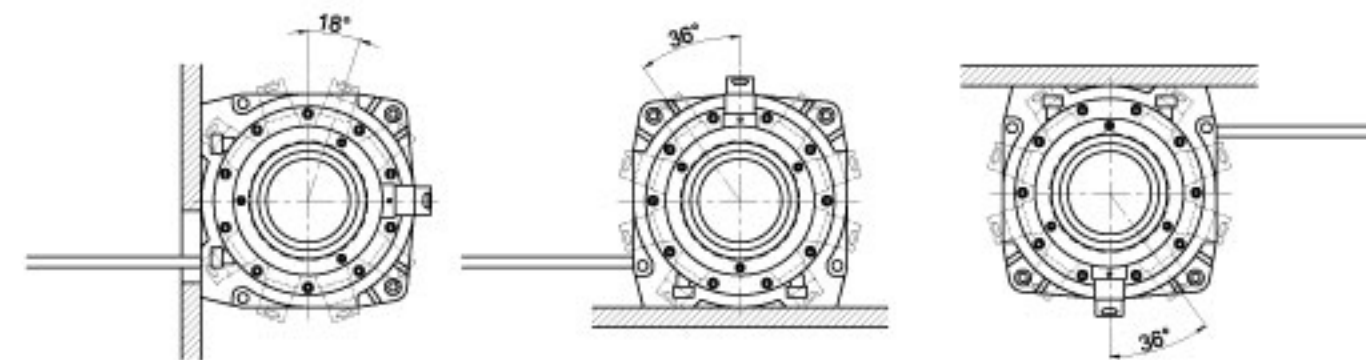
**PERFORMANCE DATA**

Line Pull and Rope Capacity		
Layer of Wire Rope	Pull by Layer, kg / lb	Total Rope on the Drum, m / ft
1 st	6,804 / 15,000	5.7 / 18.6
2 nd	5,569 / 12,277	12.6 / 41.4
3 rd	4,713 / 10,391	20.8 / 68.3
4 th	4,086 / 9,007	27 / 89

Line Speed and Amp. Draw (1 st layer of wire rope on the drum)			
Line Pull kg / lb	Line Speed mpm / fpm	Amp. Draw	
		12V	24V
No Load	6.9 / 22	60	50
1,814 / 4,000	1.6 / 5.4	180	90
3,629 / 8,000	1.2 / 3.8	280	190
4,536 / 10,000	1 / 3.3	330	220
5,443 / 12,000	0.9 / 2.9	385	260
6,804 / 15,000	0.8 / 2.5	460	340

DV-12 Self-Recovery Winch

Note: Roller fairlead does not mount to winch

- Rated Line Pull : **5,443 kg / 12,000 lb**
- Part Number : **PN 857130** 12V DC motor
PN 857228 24V DC motor

SPECIFICATIONS :

- **Rated line pull** : 5,443 kg (12,000 lb) single line
- **Motor** :
4,180 w / 5.6 hp 12V series wound
2,690 w / 3.6 hp 24V series wound
- **Gear ratio** : 3-stage planetary 261:1
- **Clutch (freespooling)** : Rotating ring gear
- **Brake (outside the drum)** : Automatic, full load CBS (Cone Brake Structure)
- **Winch construction** : Aluminum die cast housings with steel drum
- **Drum size** : 89 x 206 mm (3.5" x 8.1")
- **Control** : Waterproof remote with thermometric indicator LED w/ 5 m
- **Rope type** : Galvanized aircraft A7 x 19
- **Rope size** : 9.5 mm x 38 m (3/8" x 125')
- **Mounting bolts pattern** :
254 x 114 mm (10" x 4.5")
254 x 165 mm (10" x 6.5")
- **Winch weight (including rope)** : 55 kg / 121 lb
- **Gross weight** : 67 kg / 147.7 lb
- **Box dimension** : 695 x 265 x 420 mm (27.3" x 10.4" x 16.5")

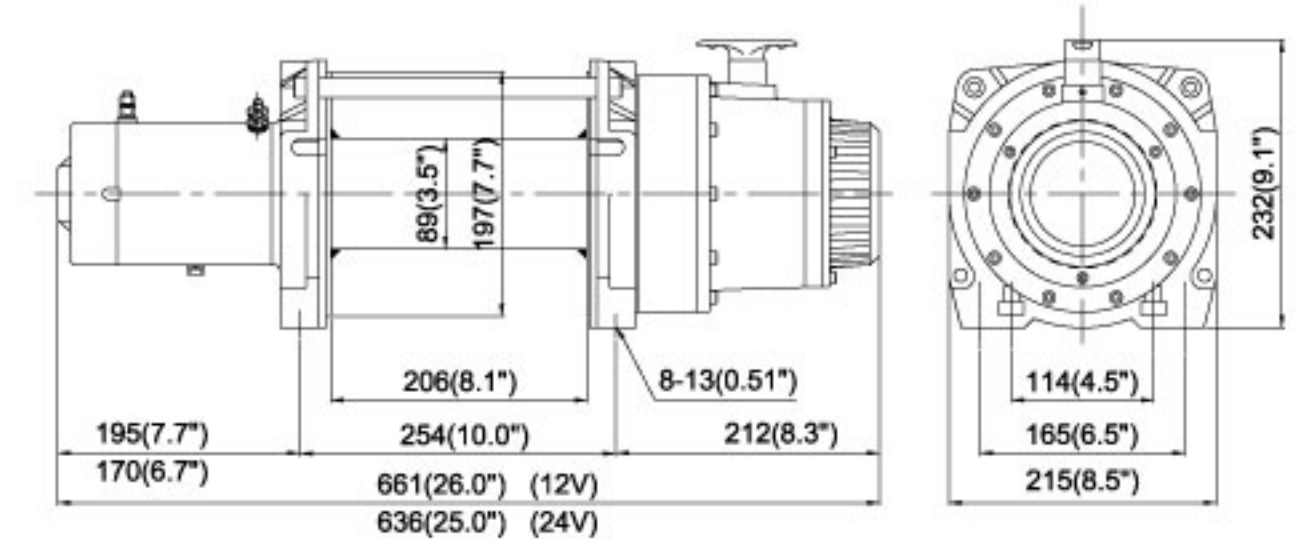
DIMENSION mm/in

- ▶ 10 equally positioned pin holes ensure seamless clutch transmission and make it easily rotate by 36° Increments.

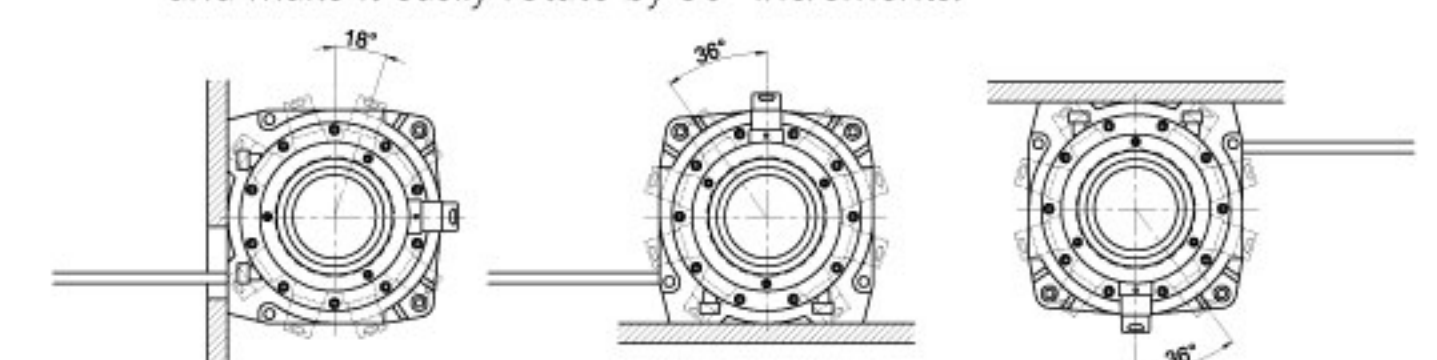
**PERFORMANCE DATA**

Line Pull and Rope Capacity		
Layer of Wire Rope	Pull by Layer, kg / lb	Total Rope on the Drum, m / ft
1 st	5,443 / 12,000	6.6 / 21.5
2 nd	4,563 / 10,060	14.4 / 47.2
3 rd	3,928 / 8,659	23.5 / 77
4 th	3,448 / 7,601	33.8 / 110.9
5 th	3,072 / 6,774	38 / 125

Line Speed and Amp. Draw (1 st layer of wire rope on the drum)			
Line Pull kg / lb	Line Speed mpm / fpm	Amp. Draw	
		12V	24V
No Load	8.3 / 27	60	50
1,814 / 4,000	2.6 / 8.6	200	100
3,629 / 8,000	1.7 / 5.8	310	190
4,536 / 10,000	1.4 / 4.4	370	230
5,443 / 12,000	1.2 / 4	440	290

- ▶ New Design Color Box for DV - 18 / 15 / 12



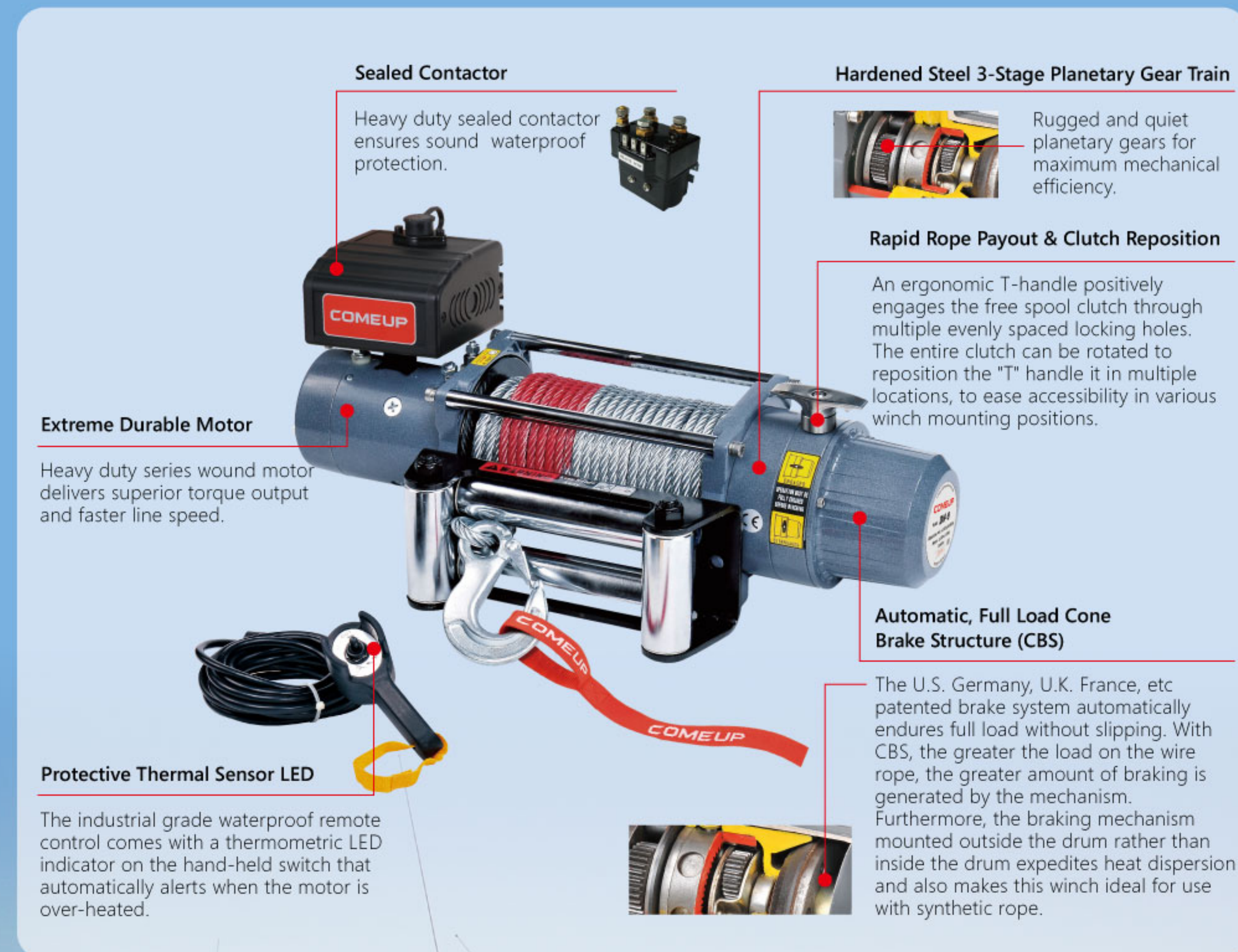

DV-12 light / 12s light Self-Recovery Winch



- Rated Line Pull : **5,443 kg / 12,000 lb**
- **DV-12 light** (wire rope)
Part Number : **PN 850012** 12V DC motor
PN 850124 24V DC motor
- **DV-12s light** (synthetic rope)
Part Number : **PN 850112** 12V DC motor
PN 851024 24V DC motor

SPECIFICATIONS : (DV-12 light/12s light)

- **Rated line pull** : 5,443 kg (12,000 lb) single line
- **Motor** :
3,430 w / 4.6 hp 12V series wound
1,940 w / 2.6hp 24V series wound
- **Gear ratio** : 3-stage planetary 211:1
- **Clutch (freespooling)** : Rotating ring gear
- **Brake (outside the drum)** : Automatic, full load CBS (Cone Brake Structure)
- **Winch construction** : Aluminum die cast housings with steel drum
- **Drum size** : 63.5 x 227 (2.5" x 8.9")
- **Control** : Waterproof remote with thermometric indicator LED w/5 m (17') cord
- **Rope type** :
DV-12 light : Galvanized aircraft A7 x 19
DV-12s light : Synthetic rope SK-75
- **Rope size** :
DV-12 light : 9.5 mm x 25 m (3/8" x 82')
DV-12s light : 11 mm x 25 m (7/16" x 82')
- **Mounting bolts pattern** : 254 x 114 mm (10" x 4.5")
- **Mounting** : Foot forward mounting only
- **Winch weight (including rope)** :
DV-12 light : 39 kg / 86 lb
DV-12s light : 30 kg / 66.1 lb
- **Gross weight** :
DV-12 light : 49 kg / 108 lb
DV-12s light : 36 kg / 79.4 lb
- **Box dimension** : 650 x 192 x 415 mm (25.6" x 7.7" x 16.3")

- ▶ New Design Color Box for
DV-12 light/12s light/9i/9si/9/9s



Less Money, Winch More

A winch with More Power in Compact size for high efficiency performance

COMEUP DV-12 light and DV-12s light are the brand new self-recovery winch specifically designed for off-roaders who have heavy loading requirements. Features such as compact size, light-weight, extreme low profile and spec-leading 12,000 lb pulling makes it the optimal winch to fit in the limited space for front-mounted installation on most of the current off-road vehicles. It comes with supreme power for safe and effective winching that enables you to **Work Tough, Play Tough** on the toughest jobs under extreme rugged environments.

PERFORMANCE DATA (DV-12 light/12s light)

Line Pull and Rope Capacity		
Layer of Rope	Pull by Layer, kg / lb	Total Rope on the Drum, m / ft
1 st	5,443 / 12,000	5.4 / 17.7
2 nd	4,319 / 9,522	12.2 / 40
3 rd	3,580 / 7,893	20.5 / 67.3
4 th	3,056 / 6,737	25 / 82

Line Speed and Amp. Draw (1st layer of rope on the drum)

Line Pull kg / lb	Line Speed mpm / fpm	Amp. Draw	
		12V	24V
No Load	8 / 26.2	50	30
1,814 / 4,000	3 / 9.8	120	70
3,629 / 8,000	1.5 / 5	230	140
4,536 / 10,000	1.2 / 4	290	180
5,443 / 12,000	1 / 3.3	350	210

DIMENSION mm/in (DV-12 light/12s light)

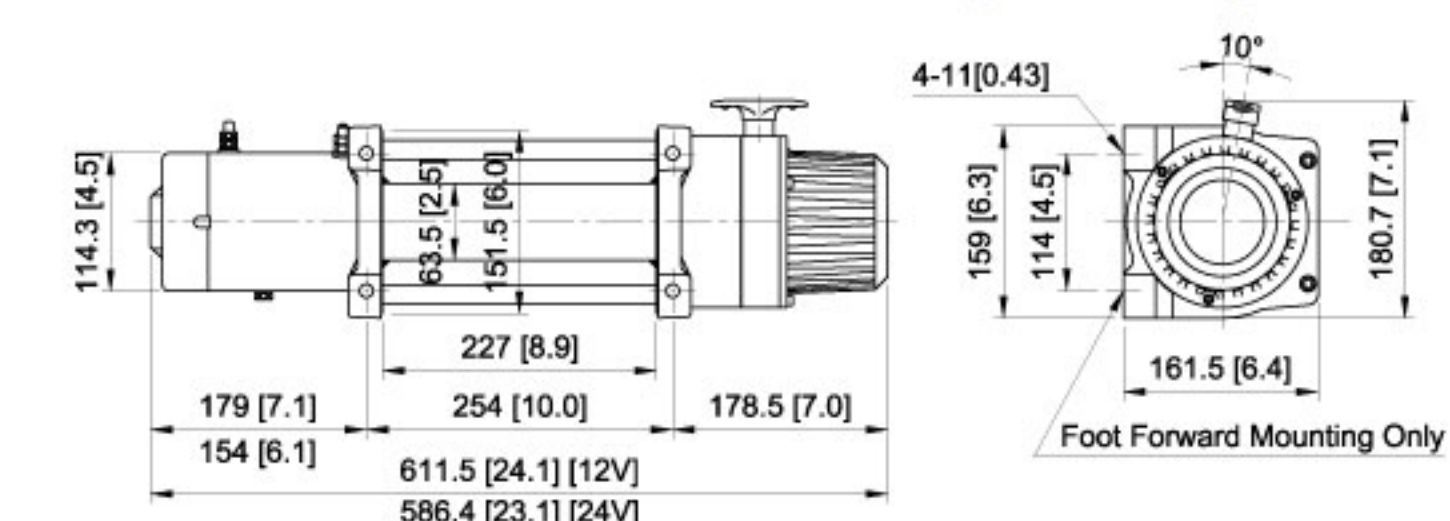

- ▶ 9 equally positioned pin holes ensure seamless clutch transmission and make it easily rotate by 40° Increments. (DV-12 light/12s light)

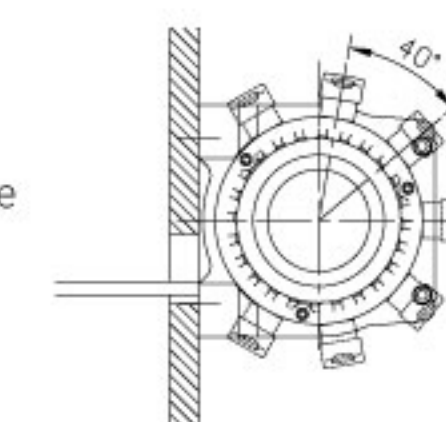

DV-9i / 9si Self-Recovery Winch

Note: Hawse fairlead does not mount to winch

- Rated Line Pull : **4,082 kg / 9,000 lb**
- **DV-9i** (wire rope)
Part Number : **PN 856360** 12V DC motor
PN 856388 24V DC motor
- **DV-9si** (synthetic rope)
Part Number : **PN 859012** 12V DC motor
PN 859013 24V DC motor

SPECIFICATIONS : (DV-9i/9si/9/9s)

- **Rated line pull** : 4,082 kg (9,000 lb) single line
- **Motor** :
3,430 w / 4.6 hp 12V series wound
1,940 w / 2.6 hp 24V series wound
- **Gear ratio** : 3-stage planetary 156:1
- **Clutch (freespooling)** : Rotating ring gear
- **Brake (outside the drum)** : Automatic, full load CBS (Cone Brake Structure)
- **Winch construction** : Aluminum die cast housings with steel drum
- **Drum size** :
DV-9i / 9 : 63.5 x 229 mm (2.5" x 9")
DV-9si / 9s : 63.5 x 227 mm (2.5" x 8.9")
- **Control** : Waterproof remote with thermometric indicator LED w/5 m (17') cord
- **Rope type** :
DV-9i / 9 : Galvanized aircraft A7 x 19
DV-9si / 9s : Synthetic rope SK-75
- **Rope size** :
DV-9i / 9 : 8.3 mm x 30.5 m (21' / 64" x 100')
DV-9si / 9s : 10 mm x 30.5 m (3' / 8" x 100')
- **Mounting bolts pattern** : 254 x 114 mm (10" x 4.5")
- **Winch weight (including rope)** :
DV-9i : 37 kg / 81.6 lb ; **DV-9si** : 31 kg / 68.3 lb
DV-9 : 33 kg / 72.8 lb ; **DV-9s** : 27 kg / 59.5 lb
- **Gross weight** :
DV-9i : 44 kg / 97 lb ; **DV-9si** : 37 kg / 81.6 lb
DV-9 : 43 kg / 94.8 lb ; **DV-9s** : 33 kg / 72.8 lb
- **Box dimension** : 650 x 192 x 415 mm (25.6" x 7.7" x 16.3")

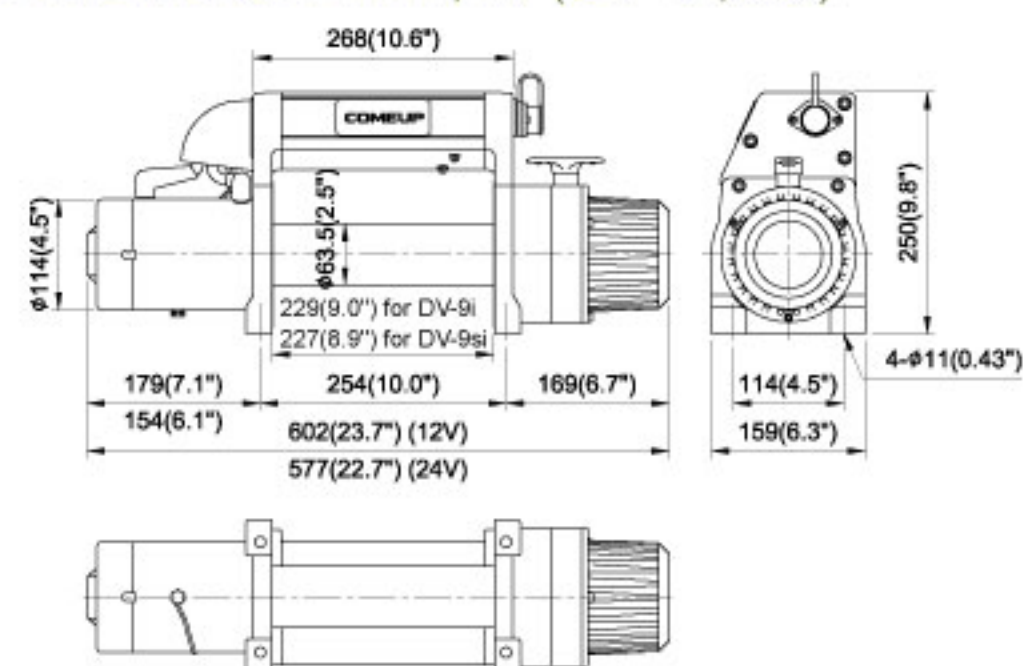
DIMENSION mm/in (DV-9i/9si)**DV-9 / 9s Self-Recovery Winch**

Note: Roller fairlead does not mount to winch

- Rated Line Pull : **4,082 kg / 9,000 lb**
- **DV-9** (wire rope)
Part Number : **PN 856329** 12V DC motor
PN 856355 24V DC motor
- **DV-9s** (synthetic rope)
Part Number : **PN 859112** 12V DC motor
PN 859113 24V DC motor

PERFORMANCE DATA(DV-9i/9si/9/9s)

Line Pull and Rope Capacity			
Layer of Rope	Pull by Layer, kg / lb	Total Rope on the Drum, m / ft	
1 st	4,082 / 9,000	6.1 / 20	
2 nd	3,316 / 7,310	13.6 / 44.7	
3 rd	2,792 / 6,154	22.6 / 74	
4 th	2,410 / 5,314	30.5 / 100	

Line Speed and Amp. Draw (1 st layer of rope on the drum)			
Line Pull kg / lb	Line Speed mpm / fpm	Amp. Draw	
		12V	24V
No Load	13.4 / 44	55	30
907 / 2,000	4.6 / 15	110	65
1,814 / 4,000	3.4 / 11	200	100
2,722 / 6,000	2.7 / 9	230	130
3,629 / 8,000	2.3 / 7.5	260	170
4,082 / 9,000	2 / 6.4	350	210

- 9 equally positioned pin holes ensure seamless clutch transmission and make it easily rotate by 40° increments.

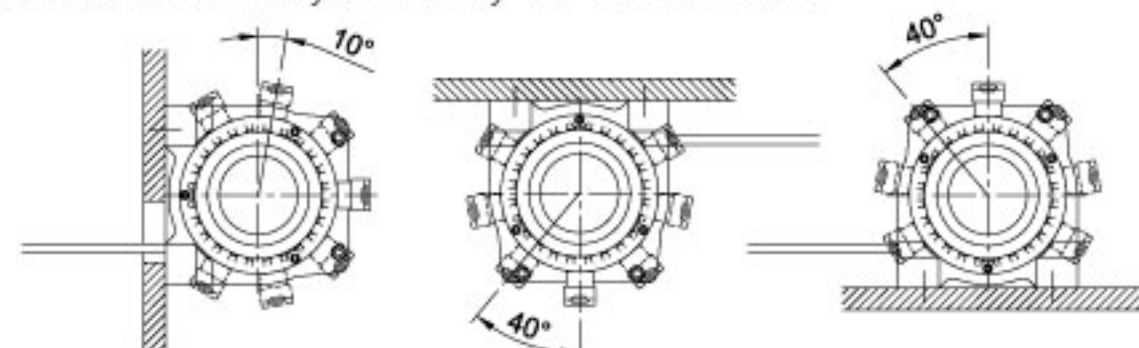
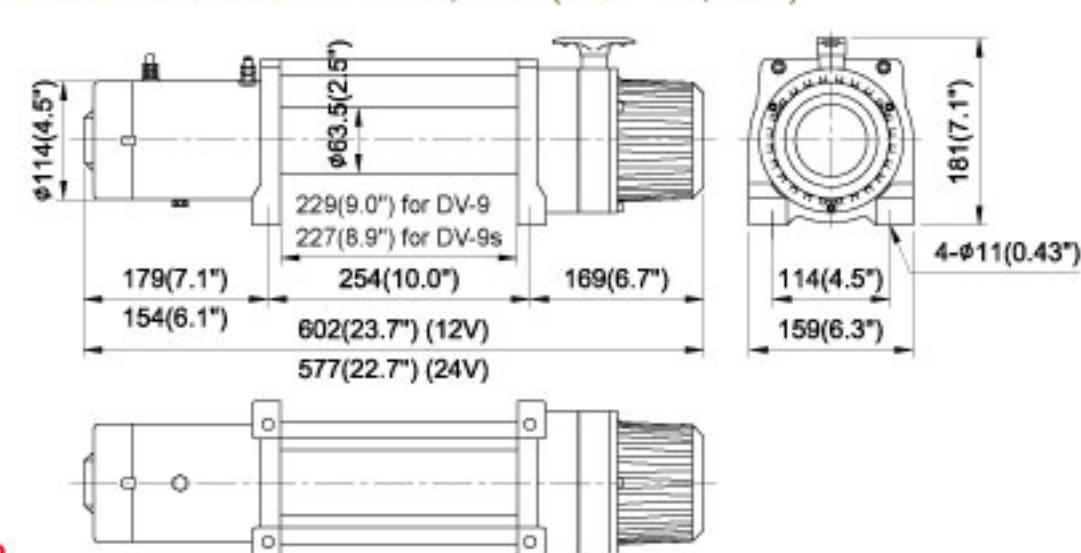
**DIMENSION mm/in (DV-9/9s)****DV-6000S Self-Recovery Winch**

Note: Roller fairlead does not mount to winch

- Rated Line Pull : **2,722 kg / 6,000 lb**
- Part Number : **PN 854756** 12V DC motor
PN 856129 24V DC motor

SPECIFICATIONS : (DV-6000S/6000L)

- **Rated line pull** : 2,722 kg (6,000 lb) single line
- **Motor** :
2,390 w / 3.2 hp 12V series wound
1,940 w / 2.6 hp 24V series wound
- **Gear ratio** : 3-stage planetary 216:1
- **Clutch (freespooling)** : Rotating ring gear
- **Brake (outside the drum)** : Automatic, full load CBS (Cone Brake Structure)
- **Winch construction** : Aluminum die cast housings with steel drum
- **Drum size** :
DV-6000S : 63.5 mm x 125.5 mm (2.5" x 4.9")
DV-6000L : 63.5 mm x 227 mm (2.5" x 8.9")
- **Control** : Waterproof remote w/5 m (17') cord
- **Rope type** : Galvanized aircraft A7 x 19
- **Rope size** :
DV-6000S : 7.1 mm x 24.4 m (9/32" x 80')
DV-6000L : 7.1 mm x 30.5 m (9/32" x 100')
- **Mounting bolts pattern** :
DV-6000S : 152.4 mm x 114 mm (6" x 4.5")
DV-6000L : 254 mm x 114 mm (10" x 4.5")
- **Winch weight (including rope)** :
DV-6000S : 28 kg / 61.7 lb
DV-6000L : 31 kg / 68.3 lb
- **Gross weight** :
DV-6000S : 32 kg / 70 lb
DV-6000L : 37 kg / 81 lb
- **Box dimension** :
DV-6000S : 505 x 210 x 340 mm (19.9" x 8.3" x 13.4")
DV-6000L : 672 x 210 x 390 mm (26.5" x 8.3" x 15.4")

- 2" rear receiver and quick connector kits mounts directly the vehicle frame without drilling, **PN 881086** as an option (DV-6000S)

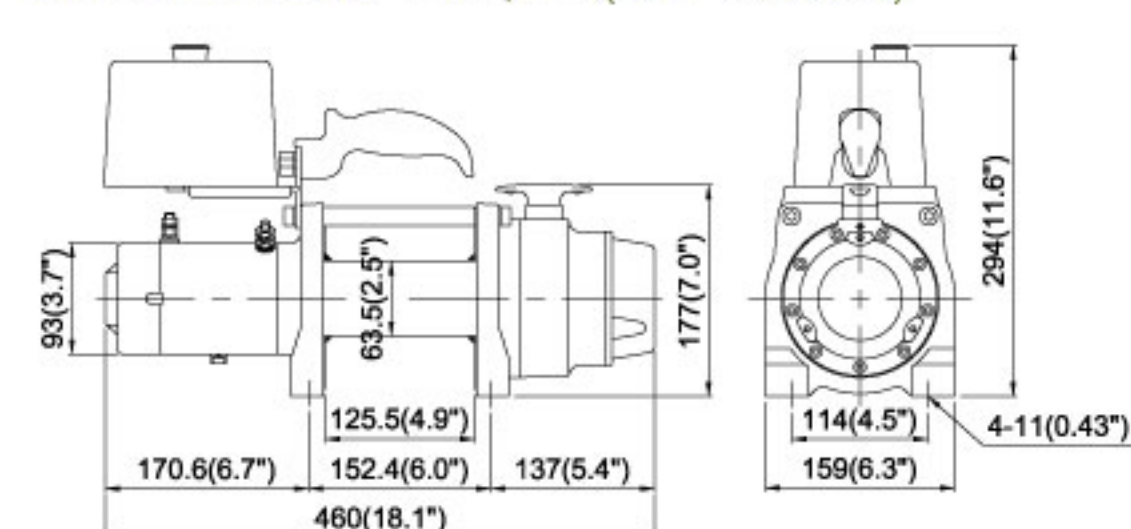
**DIMENSION mm/in (DV-6000S)****DV-6000L Self-Recovery Winch**

Note: Roller fairlead does not mount to winch

- Rated Line Pull : **2,722 kg / 6,000 lb**
- Part Number : **PN 852806** 12V DC motor
PN 854526 24V DC motor

PERFORMANCE DATA**Line Pull and Rope Capacity (DV-6000S)**

Layer of Wire Rope	Pull by Layer, kg / lb	Total Rope on the Drum, m / ft
1 st	2,722 / 6,000	3.8 / 12.5
2 nd	2,266 / 4,995	8.4 / 27.5
3 rd	1,941 / 4,279	13.7 / 45
4 th	1,697 / 3,742	19.8 / 65.1
5 th	1,508 / 3,325	24.4 / 80

Line Pull and Rope Capacity (DV-6000L)

Layer of Wire Rope	Pull by Layer, kg / lb	Total Rope on the Drum, m / ft
1 st	2,722 / 6,000	7 / 22.9
2 nd	2,266 / 4,995	15.4 / 50.4
3 rd	1,941 / 4,279	25.2 / 82.5
4 th	1,697 / 3,742	30.5 / 100

DV-6000S/DV-6000L**Line Speed and Amp. Draw (1st layer of wire rope on the drum)**

Line Pull kg / lb	Line Speed mpm / fpm	Amp. Draw	
		12V	24V
No Load	8 / 26.2	60	35
907 / 2,000	5.2 / 17	150	90
1,814 / 4,000	3.1 / 10.2	240	140
2,722 / 6,000	2 / 6.5	300	200

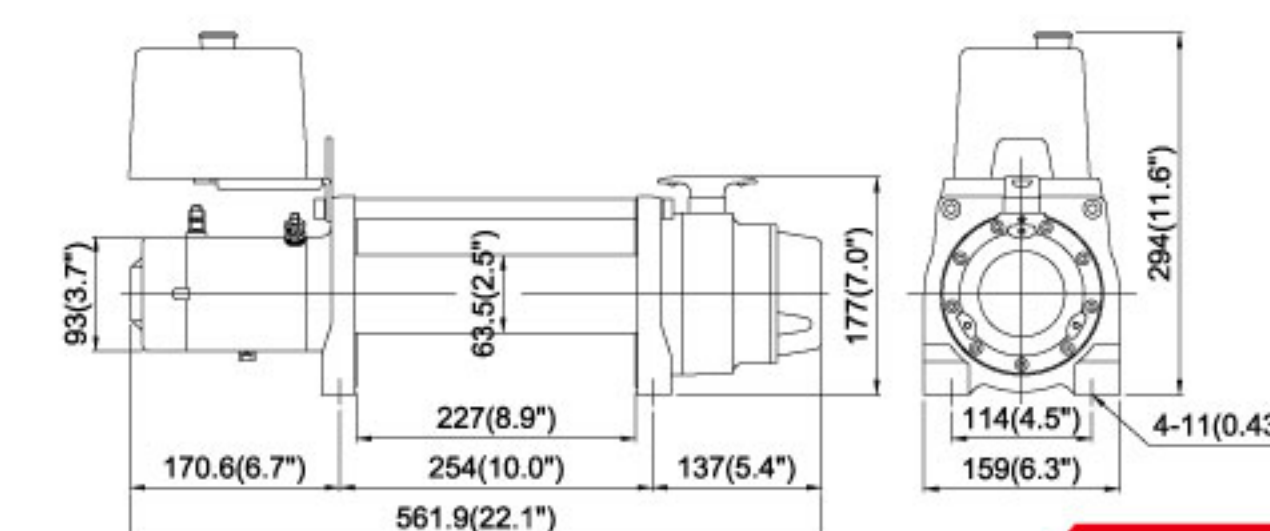
DIMENSION mm/in (DV-6000L)

UTILITY DUTY WINCH

The Utility Duty winch series are designed to be a flexible tool for loading trailers or moving various vehicles or even boats into position. COMEUP winch provide line pull of 2,500 - 4,500 lb rating with power-out device for rapid wire rope payout. They are dexterous, easy-to-install and high torque permanent magnet motor delivers high line pull at lower amp draw. Dual brakes of automatic load-holding mechanical brake and motor dynamic brake features strength and reliability

- Power in and Power out.
- High torque permanent magnet motor delivers high line pull at lower amp and slip free dynamic brake.
- 3-stage planetary gearbox delivers the most reliable and durable performance of winch under the most rugged conditions.
- Sliding pin and ring gear clutch for rapid wire rope payout.
- Automatic load-holding mechanical brake and motor dynamic brake ensure holding the load without slippage.
- Standard Compliance:

CE Machinery Directive 2006/42/EC
 CE Electromagnetic Compatibility Directive 2004/108/EC

• DV Series / 2,500 ~ 4,500 lb



DV-4500i Utility Duty Winch

- Rated Line Pull: **2,041 kg / 4,500 lb**
- Part Number: **PN 641656** 12V DC motor
PN 642037 24V DC motor

DV-3500i Utility Duty Winch

- Rated Line Pull: **1,588 kg / 3,500 lb**
- Part Number: **PN 641101** 12V DC motor
PN 641371 24V DC motor

DV-2500i Utility Duty Winch

- Rated Line Pull: **1,134 kg / 2,500 lb**
- Part Number: **PN 640333** 12V DC motor
PN 640614 24V DC motor

SPECIFICATIONS : (DV-4500i/3500i/2500i)

- **Rated line pull :**
DV-4500i : 2,041 kg (4,500 lb) single line
DV-3500i : 1,588 kg (3,500 lb) single line
DV-2500i : 1,134 kg (2,500 lb) single line
- **Motor :**
DV-4500i : 1,200 w / 1.6 hp, 12V / 24V permanent magnet
DV-3500i : 900 w / 1.2 hp, 12V / 24V permanent magnet
DV-2500i : 600 w / 0.8 hp, 12V / 24V permanent magnet
- **Gear ratio :** 3-stage planetary 170:1
- **Clutch (freespooling) :** Sliding ramping
- **Brake :** Automatic load-holding mechanical brake
- **Drum size :** 54 x 83 mm (2.1" x 3.3")
- **Control :** Handheld pendant switch remote control
- **Rope type :** Galvanized aircraft A7 x 19
- **Rope size :**
DV-4500i : 6.3 mm x 15.2 m (1/4" x 50')
DV-3500i : 5.5 mm x 15.2 m (7/32" x 50')
DV-2500i : 4.8 mm x 15.2 m (3/16" x 50')
- **Mounting bolts pattern :** 86 x 93 mm (3.4" x 3.7")
- **Winch weight (including rope) :**
DV-4500i : 14.2 kg / 31.2 lb
DV-3500i : 13.9 kg / 30.6 lb
DV-2500i : 13.5 kg / 29.7 lb
- **Gross weight :**
DV-4500i : 18.2 kg / 40 lb
DV-3500i : 17.9 kg / 39.4 lb
DV-2500i : 17.5 kg / 38.5 lb
- **Box dimension :** 462 x 271 x 185 mm (18.2" x 10.7" x 7.3")

PERFORMANCE DATA (DV-4500i)

Line Pull and Rope Capacity

Layer of Wire Rope	Pull by Layer, kg / lb	Total Rope on the Drum, m / ft
1 st	2,041 / 4,500	2.4 / 7.9
2 nd	1,688 / 3,722	5.3 / 17.4
3 rd	1,440 / 3,174	8.7 / 28.6
4 th	1,255 / 2,766	12.6 / 41.4
5 th	1,112 / 2,451	15.2 / 50

Line Speed and Amp. Draw (1st layer of wire rope on the drum)

Line Pull kg / lb	Line Speed mpm / fpm	Amp. Draw 12V	24V
No Load	6.5 / 21.3	25	10
454 / 1,000	5 / 16.4	110	55
907 / 2,000	3.6 / 11.8	210	95
1,134 / 2,500	3.2 / 10.5	240	110
1,361 / 3,000	2.5 / 8.2	270	120
1,588 / 3,500	1.8 / 5.9	290	140
1,814 / 4,000	1.4 / 4.6	310	155
2,041 / 4,500	0.4 / 1.3	330	170



- Compact and light weight allows a wide range of appuication on trailers and boats
- Circuit breakers shut off winch to prevent overheating of motor
- Integrated solenoid pack for better protection of wirings

PERFORMANCE DATA (DV-3500i)

Line Pull and Rope Capacity

Layer of Wire Rope	Pull by Layer, kg / lb	Total Rope on the Drum, m / ft
1 st	1,588 / 3,500	2.7 / 8.9
2 nd	1,340 / 2,954	6 / 19.6
3 rd	1,159 / 2,555	9.7 / 31.8
4 th	1,021 / 2,251	13.9 / 45.7
5 th	913 / 2,012	15.2 / 50

Line Speed and Amp. Draw (1st layer of wire rope on the drum)

Line Pull kg / lb	Line Speed mpm / fpm	Amp. Draw 12V	24V
No Load	6.5 / 21.3	25	10
454 / 1,000	5 / 16.4	110	55
907 / 2,000	3.6 / 11.8	200	100
1,134 / 2,500	3.2 / 10.5	230	115
1,361 / 3,000	2.5 / 8.2	260	140
1,588 / 3,500	1.8 / 5.9	300	180

PERFORMANCE DATA (DV-2500i)

Line Pull and Rope Capacity

Layer of Wire Rope	Pull by Layer, kg / lb	Total Rope on the Drum, m / ft
1 st	1,134 / 2,500	3.1 / 10.2
2 nd	975 / 2,149	6.7 / 22
3 rd	855 / 1,885	10.8 / 35.5
4 th	761 / 1,678	15.2 / 50

Line Speed and Amp. Draw (1st layer of wire rope on the drum)

Line Pull kg / lb	Line Speed mpm / fpm	Amp. Draw 12V	24V
No Load	5 / 16.4	30	10
454 / 1,000	3.5 / 11	80	55
907 / 2,000	2.3 / 7.5	150	115
1,134 / 2,500	1.3 / 4.2	200	140

DIMENSION mm/in (DV-4500i/3500i/2500i)

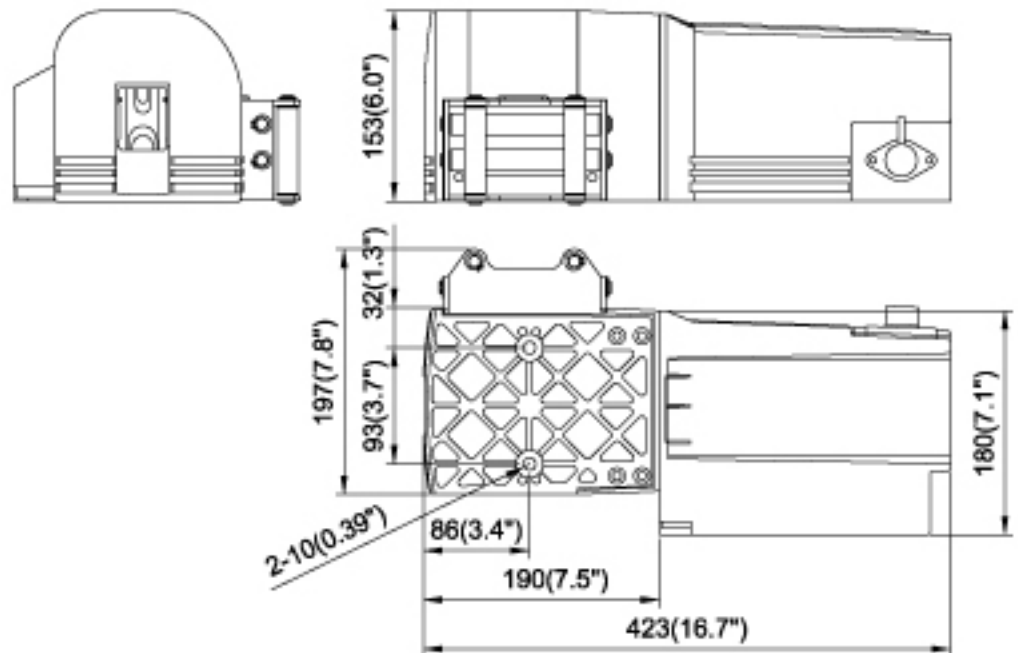

Wireless Remote Control Accessories

Part Number: **PN 881262** for automotive winches with a 6-pin plug

COMEUP wireless remote control communicates by a 2.4GHz digital transmission frequency. It delivers a reliable connection covering up to 27m (90') radius without interference. Users will experience virtually no interference and no time-lag operation when multiple devices are used in the same working area. The two-way communications provides feedback on signal receiving and it requires no manual configuration. It's easy to install. By simple plug-and-play, it starts working within seconds. Each pairing transmitter links up and stays linked automatically. You never have to worry about anyone having the same frequency. The sooner they are installed, the faster they work.

- Works with any 12 or 24 volt contact-switched automotive winches. (Except Seal 9.5r/9.5rs/9.5ri/9.5rsi/12.5r/12.5rs)
- 2.4 GHz wireless technology works within 27m (90') radius and the anti-interference function lets you move around an obstacle for winching.
- Stylish and ergonomic design fits comfortably in your hand.
- Power is switched on after a 5-second continuous press for safety.
- Power is cut after 5-minutes of inactivity for safety and for conserving battery life.
- The transmitter can be self-coded, simplifying installation and replacement.

SPECIFICATIONS :

- **Frequency** : 2.4 GHz
- **Remote range** : up to 27 m (90')
- **LED indication** : Green light for power on.
Red light for winching.
Blinking green light for low battery life.
Blinking red light for poor signal received.
- **Transmitter** : 3V lithium battery, weight: 60 g / 2.1 oz
- **Receiver** : DC 8-24V rated 7.5A, weight: 150 g / 5.3 oz
- **WARRANTY** : Each new wireless remote control is guaranteed against defects in workmanship and material defects for period of one (1) year from date of purchase.

DIMENSION mm/in

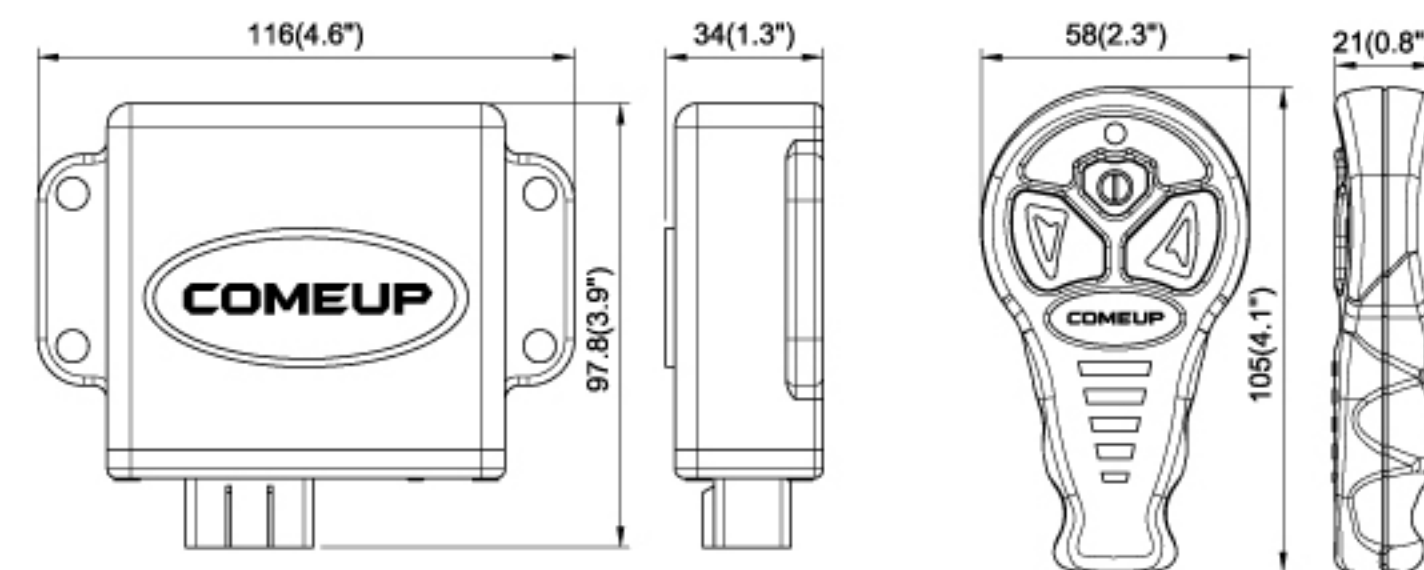

Winch Accessory Kit Accessories

Medium Duty Kit

Part Number: **PN 881662** for DV-6000S/6000L, DV-9/9s, DV-9i/9si Seal 9.5/9.5s/9.5rs, Seal 9.5i/9.5si/9.5rsi

Designed for winch single line capacity to 4,309 kg / 9,500 lb Includes:

- 10,000 kg / 22,000 lb maximum capacity snatch block, **PN 881079**
- 100 mm x 2.4 m (4" x 8') tree trunk protector strap, **PN 881091**
- 75 mm x 9 m (3" x 30') recovery strap rated to 9,800 kg / 21,600 lb, **PN 881090**
- Bow Shackle, 20 mm (3/4") pin diameter, **PN 881092**
- Recovery damper, **PN 881557**
- Leather gloves, **PN 881558**
- Duffel bag, **PN 881661**



Heavy Duty Kit

Part Number: **PN 882068** for DV-15/12, DV-12 light/12s light, Seal 12.5/12.5s/12.5rs

Designed for winch single line capacity to 6,803 kg / 15,000 lb Includes:

- 13,610 kg / 30,000 lb maximum capacity snatch block, **PN 881082**
- 100mm x 2.4m (4" x 8') tree trunk protector strap, **PN 881091**
- 75mm x 9m (3" x 30') recovery strap rated to 9,800 kg / 21,600 lb, **PN 881090**
- Bow Shackle, 20 mm (3/4") pin diameter, **PN 881092**
- 3 m of 8 mm (10' of 5/16") grade 70 choker chain with hooks, **PN 881096**
- Recovery damper, **PN 881557**
- Leather gloves, **PN 881558**
- Duffel bag, **PN 881661**



Synthetic Rope

- The new synthetic fiber rope is made from Dyneema SK-75 specifically designed to replace steel wire ropes.
- Lightweight, high strength and no water absorption.
- A 12 strand construction rope coated to improve abrasion resistance and to protect the rope from the ingress of dirt and grit.



▲ **Clevis Hook 1/2" , PN 882024**
(clevis hook is sold separately)

- PN 882025** w/o hook for Seal 9.5s/9.5rs/9.5si/9.5rsi, DV-9s/9si
- 30.5 m (100') of 10 mm (3/8") diameter synthetic rope designs for off-road winches application with line pull of 4,309 kg (9,500 lb) or less.

- PN 881649** w/o hook for Seal 12.5s/12.5rs, DV-12s light
- 25 m (82') of 11 mm (7/16") diameter synthetic rope designs for off-road winches application with line pull of 5,670 kg (12,500 lb) or less.

Wire Rope with hook

- PN 881246**
11.1 mm X 27.1 m for DV-15
- PN 880052**
9.5 mm X 38.1 m for DV-12



- PN 881522**
9.5 mm X 25 m for DV-12 light, Seal 12.5
- PN 880112** 8.7 mm X 30.5 m for Seal 9.5/9.5i
- PN 880010** 8.3 mm X 30.5 m for DV-9/9i
- PN 880083** 7.1 mm X 24.4 m for DV-6000S
- PN 881060** 7.1 mm X 30.5 m for DV-6000L
- PN 881929** 12.7 mm X 25 m w/o hook for DV-18
- PN 880305** 6.3 mm X 15.2 m for DV-4500i
- PN 880298** 5.5 mm X 15.2 m for DV-3500i
- PN 880288** 4.8 mm X 15.2 m for DV-2500i

Bow Shackles

- 20 mm (3/4") pin diameter, **PN 881092**



Emergency Stop Switch, PN 881668 400A

Battery Isolation Switch PN 881097

- 2 Position Off-On 12V 500 Amp for DV/Seal Series Winch

**Recovery Damper**

A recovery damper is a safety device designed to help eliminate the possibility of injury or property damage in the event of a wire rope failure. **PN 881557**

**Leather Gloves**

Always use leather gloves when handling the wire/synthetic rope to protect your hands. **PN 881558**

**Recovery Strap**

Use a recovery strap to snatch or pull out a stuck vehicle.

- 9,800 kg / 21,600 lb recovery strap 75 mm x 9 m (3" x 30') , **PN 881090**

**Tree Trunk Protector Strap**

A tree trunk protector strap is useful for connecting a winch wire rope to almost any anchor point but is primarily designed to prevent damage to the tree trunk.

- 13,610 kg / 30,000 lb tree trunk protector 100 mm x 2.4 m (4" x 8') , **PN 881091**

**Detachable Control Box**

- PN 880098** (12V) / **PN 880099** (24V)
for DV-6000S/6000L



- PN 881164** (12V)
for DV-9/9s, DV-12 light/12s light, DV-12/15,
Seal 9.5/9.5s, Seal 12.5/12.5s



- PN 881165** (24V)
for DV-9/9s, DV-12 light/12s light, DV-12/15/18,
Seal 9.5/9.5s, Seal 12.5/12.5s

- PN 881168** (12V)
for Seal 9.5rs/12.5rs,
built-in wireless receiver

Bridge Control Box

- PN 881160** (12V) / **PN 881161** (24V)
for DV-9i
- PN 881170** (12V)
for Seal 9.5rsi, built-in wireless receiver
- PN 880351** (12V)
for Seal 9.5i/9.5si

**Roller Fairlead**

- PN 880289** 63 mm throat for DV-2500i/3500i/4500i
- PN 880066** 180 mm throat for DV-12/15/18
- PN 880096** 109 mm throat for DV-6000S
- PN 880023** 210 mm throat for DV-6000L,
DV-9/9i/12 light,
Seal 9.5, Seal 9.5i, Seal 12.5

**Snatch Block**

- PN 881079** Max. load 10,000 kg / 22,000 lb
for DV-6000S/6000L, DV-9/9s, DV-9i/9si,
Seal 9.5/9.5s/9.5rs, Seal 9.5i/9.5si/9.5rsi



- PN 881080**
Max. load 5,000 kg / 11,000 lb
for DV-2500i/3500i/4500i



- PN 881082**
Max. load 13,610 kg / 30,000 lb
for DV-12 light/12s light, DV-12/15,
Seal 12/12.5s/12.5rs

**Cable Tensioner**

- PN 881087** 204 mm for DV-12/15/18

**Quick Connector**

- PN 881075** 50A **PN 881076** 175A

**DC Solenoid**

- PN 881077** (12V) / **PN 881078** (24V)
for DV-2500i/3500i/4500i, DV-6000S/6000L

**Sealed Contactor**

- PN 881355** (12V) / **PN 881356** (24V)
400A, for DV-9/9s, DV-9i/9si,
DV-12 light/12s light, DV-12/15/18,
Seal 9.5/9.5s/9.5rs, Seal 9.5i/9.5si/9.5rsi,
Seal 12.5/12.5s/12.5rs

**Hawse Fairlead**

- PN 881061** 184 mm throat for
Seal 9.5s/9.5rs/9.5si/9.5rsi,
Seal 12.5s/12.5rs, DV-9s,
DV-9si, DV-12s light

**Remote Control**

- PN 880295**
for DV-2500i/3500i/4500i
- PN 880025**
for DV-6000S/6000L
- PN 880126**
for Seal 9.5/9.5s/9.5rs,
Seal 9.5i/9.5si/9.5rsi,
Seal 12.5/12.5s/12.5rs,
DV-9/9s, DV-9i/9si,
DV-12 light/12s light, DV-12/15/18
(coming with protective
thermal sensor LED)

**Mounting Channel**

- PN 881083** Front mounting for
DV-6000L, DV-9/9s, DV-9i/9si,
Seal 9.5/9.5s/9.5rs,
Seal 9.5i/9.5si/9.5rsi



- PN 881085** Front mounting for
DV-12/15

- PN 881084** Multi-purpose mounting for
DV-6000L, DV-9/9s, DV-9i/9si,
Seal 9.5/9.5s/9.5rs,
Seal 9.5i/9.5si/9.5rsi



- PN 881086**
Rear mounting ass'y for DV-6000S



Automotive Winch Accessories Chart (Seal Series)

Model Number		Seal 12.5	Seal 12.5s	Seal 12.5rs	Seal 9.5	Seal 9.5s	Seal 9.5rs	Seal 9.5i	Seal 9.5si	Seal 9.5rsi
Line Pull	kg	5,670	5,670	5,670	4,309	4,309	4,309	4,309	4,309	4,309
	lb	12,500	12,500	12,500	9,500	9,500	9,500	9,500	9,500	9,500
Remote Control		●	●	●	●	●	●	●	●	●
Control Box	12V	●	●	●	●	●	●	●	●	●
	24V	-	-	-	-	-	-	-	-	-
Wire Rope w/Hook		●	-	-	●	-	-	●	-	-
Synthetic Rope w/Hook		-	●	●	-	●	●	-	●	●
Roller Fairlead		●	-	-	●	-	-	●	-	-
Hawse Fairlead		-	●	●	-	●	●	-	●	●
Circuit Breaker		◎	◎	◎	◎	◎	◎	◎	◎	◎
Battery Lead		●	●	●	●	●	●	●	●	●
Handsaver Strap		●	●	●	●	●	●	●	●	●
Cable Tensioner		-	-	-	-	-	-	-	-	-
Snatch Block		◎	◎	◎	◎	◎	◎	◎	◎	◎
Mounting Channel		◎	◎	◎	◎	◎	◎	◎	◎	◎
Winch Accessory Kit		◎	◎	◎	◎	◎	◎	◎	◎	◎
Wireless Remote Control		◎	◎	Built-in	◎	◎	Built-in	◎	◎	Built-in
Recovery Damper		●	●	●	●	●	●	●	●	●
Gloves		●	●	●	●	●	●	●	●	●

● Means as a standard accessory / ◎ Means as an option accessory



Automotive Winch Accessories Chart (DV Series)

Model Number		DV-18	DV-15	DV-12	DV-12 light	DV-12s light	DV-9	DV-9s	DV-9i	DV-9si	DV-6000S	DV-6000L	DV-4500i	DV-3500i	DV-2500i
Line Pull	kg	8,181	6,803	5,443	5,443	5,443	4,082	4,082	4,082	4,082	2,722	2,722	2,041	1,588	1,134
	lb	18,000	15,000	12,000	12,000	12,000	9,000	9,000	9,000	9,000	6,000	6,000	4,500	3,500	2,500
Remote Control		●	●	●	●	●	●	●	●	●	●	●	●	●	●
Control Box	12V	-	●	●	●	●	●	●	●	●	●	●	Built-in	Built-in	Built-in
	24V	●	●	●	●	●	●	●	●	●	●	●	Built-in	Built-in	Built-in
Wire Rope w/Hook		●	●	●	●	-	●	-	●	-	●	●	●	●	●
Synthetic Rope w/Hook		-	-	-	-	●	-	●	-	●	-	-	-	-	-
Roller Fairlead		●	●	●	●	-	●	-	●	-	●	●	●	●	●
Hawse Fairlead		-	-	-	-	●	-	●	-	●	-	-	-	-	-
Circuit Breaker		◎	◎	◎	◎	◎	◎	◎	◎	◎	◎	◎	◎	◎	◎
Battery Lead		●	●	●	●	●	●	●	●	●	●	●	●	●	●
Handsaver Strap		●	●	●	●	●	●	●	●	●	●	●	●	●	●
Cable Tensioner		◎	◎	◎	-	-	-	-	-	-	-	-	-	-	-
Snatch Block		-	◎	◎	◎	◎	◎	◎	◎	◎	◎	◎	◎	◎	◎
Mounting Channel		-	◎	◎	-	-	◎	◎	◎	◎	◎	◎	◎	◎	◎
Winch Accessory Kit		-	◎	◎	◎	◎	◎	◎	◎	◎	◎	◎	◎	◎	◎
Wireless Remote Control		◎	◎	◎	◎	◎	◎	◎	◎	◎	◎	◎	◎	◎	◎
Recovery Damper		◎	◎	◎	◎	◎	◎	◎	◎	◎	◎	◎	◎	◎	◎
Gloves		◎	◎	◎	◎	◎	◎	◎	◎	◎	◎	◎	◎	◎	◎

● Means as a standard accessory / ◎ Means as an option accessory